

**PRODUCT WEIGHT**  
**90 Lbs.**

**WIDTH x DEPTH x HEIGHT**

**50x 14 x 59**

**CAPACITY**

**Shelf lip up, 100  
Lbs/shelf evenly  
distributed.  
Shelf lip down, 200  
Lbs/shelf evenly  
distributed.**

**COLOR**

**GRAY**

**CATALOG NUMBER**

**HAD5059**

### **PRODUCT FEATURES**

**This product is designed for installation in a higher roof vehicle, like the Chrysler Promaster, Ford Transit, Nissan NV.**

**This shelving unit uses a 14" deep end panel that is 59" tall that maximizes vehicle storage capacity. The top and bottom shelves are traditional bolt together shelves, and the middle shelves are AD series shelves and are truly adjustable to meet your needs.**

**SEE PAGE 2 FOR APPLICATION NOTES AND ACCESSORIES, OTHER PRODUCTS THAT WORK WITH THIS UNIT.**

**PAGE 1 of 2**

The information contained in this document is the sole property of ADRIAN STEEL COMPANY. ADRIAN STEEL COMPANY retains the right to modify and/or change the product of its design at any time without prior notification.

**CATALOG NUMBER    HAD5059*****PRODUCT APPLICATION***

This shelving unit uses a 14” deep end panel that is 59” tall that maximizes vehicle storage capacity. The top and bottom shelves are traditional bolt together shelves, and the middle shelves are AD series shelves and are truly adjustable to meet your needs.

***ACCESSORIES THAT WILL WORK WITH THIS PRODUCT***

<b>CATALOG NUMBER</b>	<b>DESCRIPTION</b>
35317-G	DIVIDER AD SERIES SHELVING
DC6	DRAWER COMPONENT 6" WIDE
DC12	DRAWER COMPONENT 12" WIDE
9	4-DRWER SHALLOW
19	2-DRAWER MEDIUM
919	3-DRAWER COMBO
UH50	HOOK, 5"
UH10	UTILITY HOOK, 1"
UH25	UTILITY HOOK, 2.5"
UH50	HOOK, 5"
TA1	FOUR HOOK BAR

***SPECIAL APPLICATION NOTES***

Additional accessories may be compatible with this product. Please consult with ADRIAN STEEL ENGINEERING to review specific applications not listed here.

**PAGE 2 of 2**

**Introduction / Comments:**

Knock Down Shelving for Medium/High roof vehicles. These units have tall end panels and use formed shelves at the top and bottom. The center shelves use the AD series style and are easily adjustable after installation.

**Note:**

It is advised that all fasteners used in this assembly and installation should be checked for tightness at the following intervals: @ 2-weeks and again @ 6-weeks of operation. This preventive maintenance step must be completed to ensure your Shelving gives you long service life.

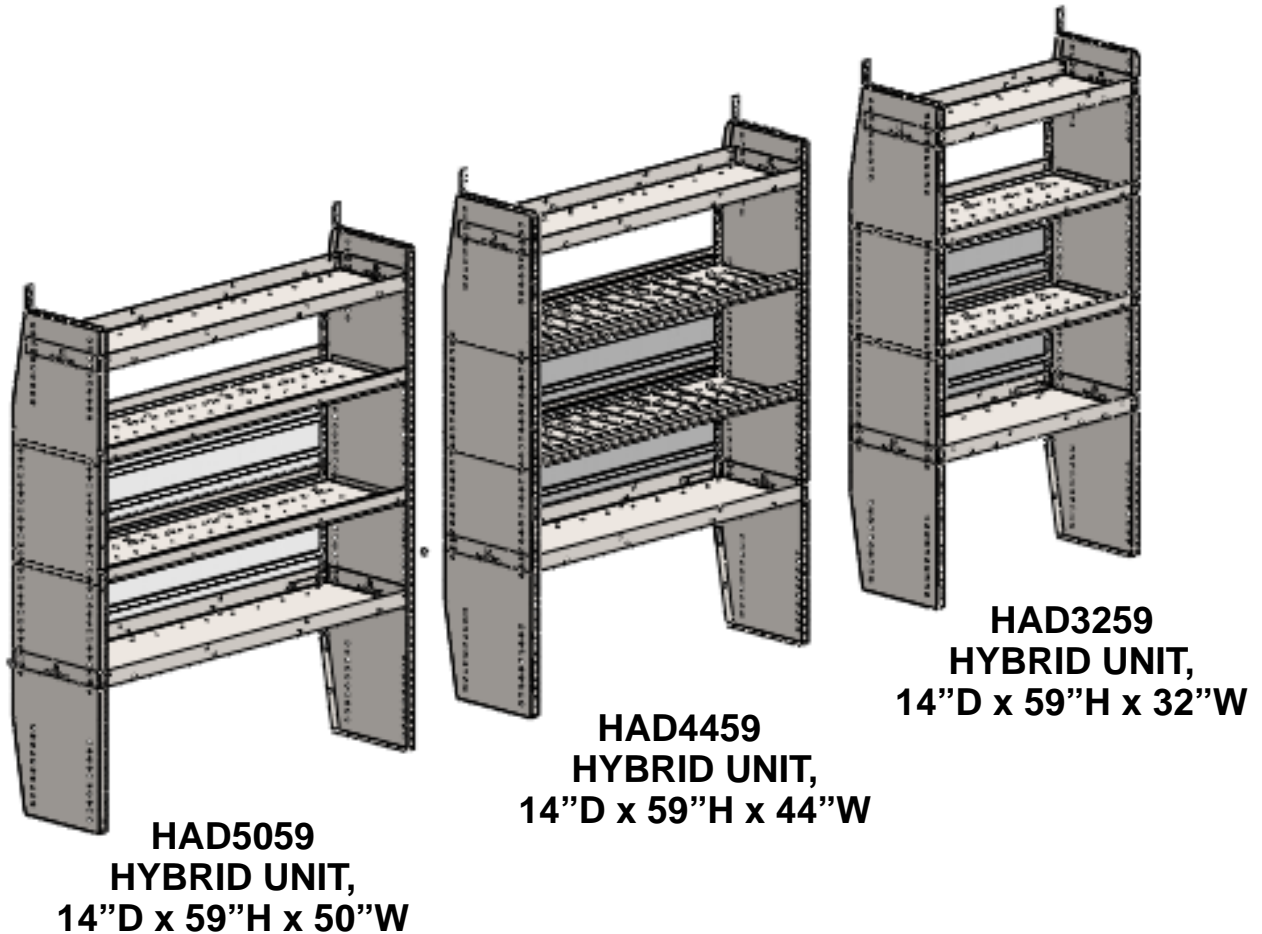

## - PRECAUTIONS -





 **CAUTION**   
**THE USE OF AIR IMPACT TOOLS CAN  
OVER-TORQUE FASTENERS AND  
CAUSE FASTENER FAILURE!**



 **CAUTION**   
**ALL INSTALLATION HOLES SHOULD BE SEALED  
WITH SILICON OR BUTYL SEALANT TO PREVENT  
EXHAUST FUMES FROM ENTERING THE VEHICLE!**



 **DANGER**   
**INSPECT FOR FUEL TANK, FUEL LINES, BRAKE LINES, HIGH  
VOLTAGE BATTERIES AND ELECTRICAL LINES PRIOR TO  
DRILLING TO AVOID DAMAGING CRITICAL VEHICLE SYSTEMS  
OR INJURY TO INSTALLER DURING INSTALLATION PROCESS!**



 **CAUTION**   
**TO AVOID DAMAGING THE VEHICLE ALWAYS  
USE DRILL STOPS WHEN DRILLING ANY IN-  
STALLATION HOLES!**



## - IMPORTANT WARRANTY REQUIREMENTS -

1. SUBSTITUTING ADRIAN STEEL SPECIFIED FASTENERS FOR ASSEMBLY AND/OR INSTALLATION WILL VOID YOUR PRODUCT WARRANTY.
2. ALL HOLES DRILLED INTO VEHICLE SHOULD HAVE THE RAW METAL EDGES SEALED WITH A SELF-ETCHING PRIMER TO RESIST CORROSION AND POTENTIAL FASTENER POINT FAILURE.
3. ALL FASTENERS USED IN THE INSTALLATION OF THIS PRODUCT SHOULD BE TIGHTENED TO THE TORQUE(S) SPECIFIED IN THESE INSTRUCTIONS.
4. THESE INSTRUCTIONS SHOULD BE KEPT WITH THE VEHICLE.

### THE BASIC TOOLS NEEDED FOR MOST INSTALLATIONS



DRILL



DRILL BIT WITH  
STOP



RATCHET, SOCKETS  
AND/OR WRENCHES



SCREWDRIVERS



MEASURING TAPE

ADDITIONAL TOOLS MAY BE NEEDED FOR THIS INSTALLATION AND THEY WILL BE IDENTIFIED IN THE STEPS THAT FOLLOW.

If your vehicle contains carpet or a rubber floor mat you will need to prepare the mounting location. Position the product to be installed into the vehicle and once you are satisfied with the mounting locations, mark the mounting locations. Using a 1-3/16" diameter carpet cutter (P/N: 31183-0). Select the appropriate floor spacers as shown in the illustration. Set those aside for use later into the installation process. Using the correct drill bit size for the selected plusnut, drill the mounting holes in the vehicle sheet metal to prepare for installing the plusnuts. If you are thru-bolting at any of the locations simply drill a hole that is 1/16" larger than the bolt size(s) for those locations. Once you have drilled the holes into the vehicle, the raw metal edges should be sealed using a self-etching primer to resist corrosion and potential fastener point failure.

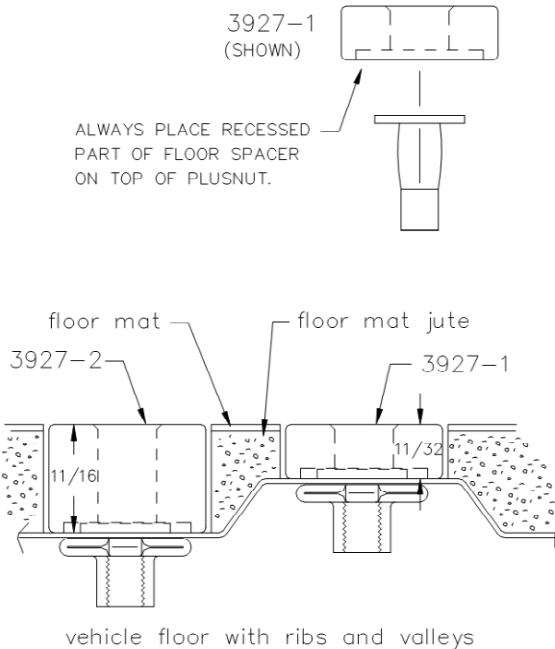

A PLUSNUT (RIVNUT) SETTING TOOL IS REQUIRED FOR PLUSNUT (RIVNUT) INSTALLATION AND IS SUPPLIED WITH THIS KIT. OR USE AN AIR POWERED PLUSNUT SETTING GUN.

1/4-20UNC Plusnut (FAS0052) Use 3/8" dia. drill w/stop  
 FAS0080 SCREW, HXHD, 1/4-20UNCx2.00", G8  
 FAS0067 WASHER, FLAT, 1/4"ID  
 22200-0 PLUSNUT TOOL

5/16-18UNC Plusnut (FAS0091) Use 1/2" dia. drill w/stop  
 FAS0095 SCREW, HXHD, 5/16-18UNCx2.00", G8  
 FAS0086 WASHER, FLAT, 5/16"ID  
 22200-0 PLUSNUT TOOL

Place barrel of the plusnut body in sheet metal thru hole until flange is flush with sheet metal. Using a 9/16" combination wrench of plusnut tool body and a second hand wrench, ratchet, or air tool, rotate the hex bolt head CW to draw plus nut flanges up (set the plusnut).

## Assembly and Installation Fastener Identification Sheet ( BAGADXXFP )

ITEM NO.	PART NUMBER	DESCRIPTION	BAGADXXFP/QTY.
1	BAG0406-A	4" X 6" 3MIL AUTOBAG	1
2	FAS0061	Screw, Truss Hd. Ph, 1/4-20x0.50	6
3	FAS0712	RIVET AND WASHER ASSEMBLY	12

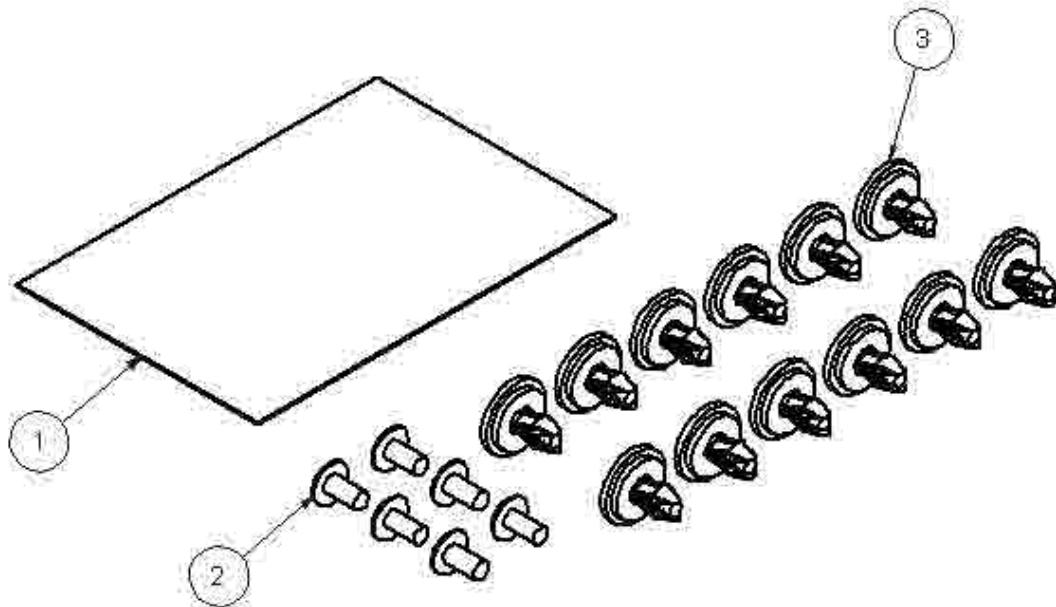

### Assembly and Installation Fastener Identification Sheet (BAGHADINST)

A1	PART NUMBER	DESCRIPTION	BAGHADINST/QTY.
1	FAS0091	Plusnut, 5/16	6
2	FAS0098	Washer, Lock, Split, 5/16, Zinc Plate	6
3	FAS0086	WASHER,FLAT USS 5/16 ZP	10
4	BAG0507-A	5" x 7" 3MIL AUTOBAG	1
5	FAS0090	Nut, Nylon Insert Lock, 5/16-18, Zi	4
6	FAS0081	Screw, Hex Hd, 5/16-18x0.75 Zn Plate	6
7	03927-2	Tall Floor Spacer	4
8	03927-1	Floor Spacer Short	4
9	FAS0095	Screw, Hex Hd, 5/16-18x2.00 , Grade 8	4
10	22200-0	Plus Nut tool	1

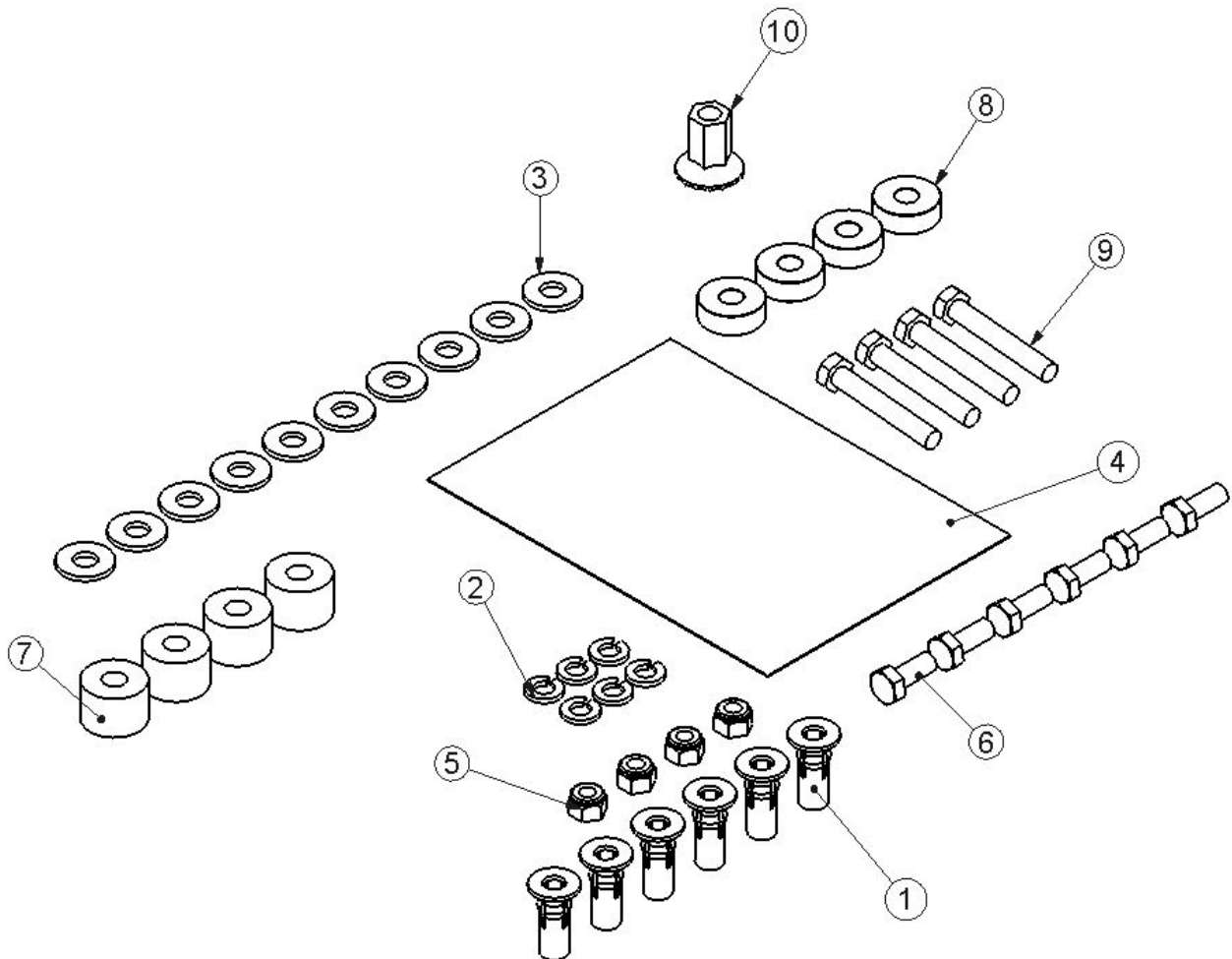

## Assembly and Installation Fastener Identification Sheet ( BAG00046-0 )

ITEM NO.	PART NUMBER	DESCRIPTION	QTY
1	BAG0507-A	5" x 7" 3MIL AUTOBAG	1
2	FAS0061	Screw, Truss Hd. Ph, 1/4-20x0.50	52
3	FAS0055	Nut, Hex Flange, Nylock 1/4-20	52
4	FAS0067	Washer, Flat, 1/4	10
5	FAS0020	Nut, Hex Flange, #10-24	10
6	FAS0025	Screw, Truss Hd. Ph, #10-24x0.50	10

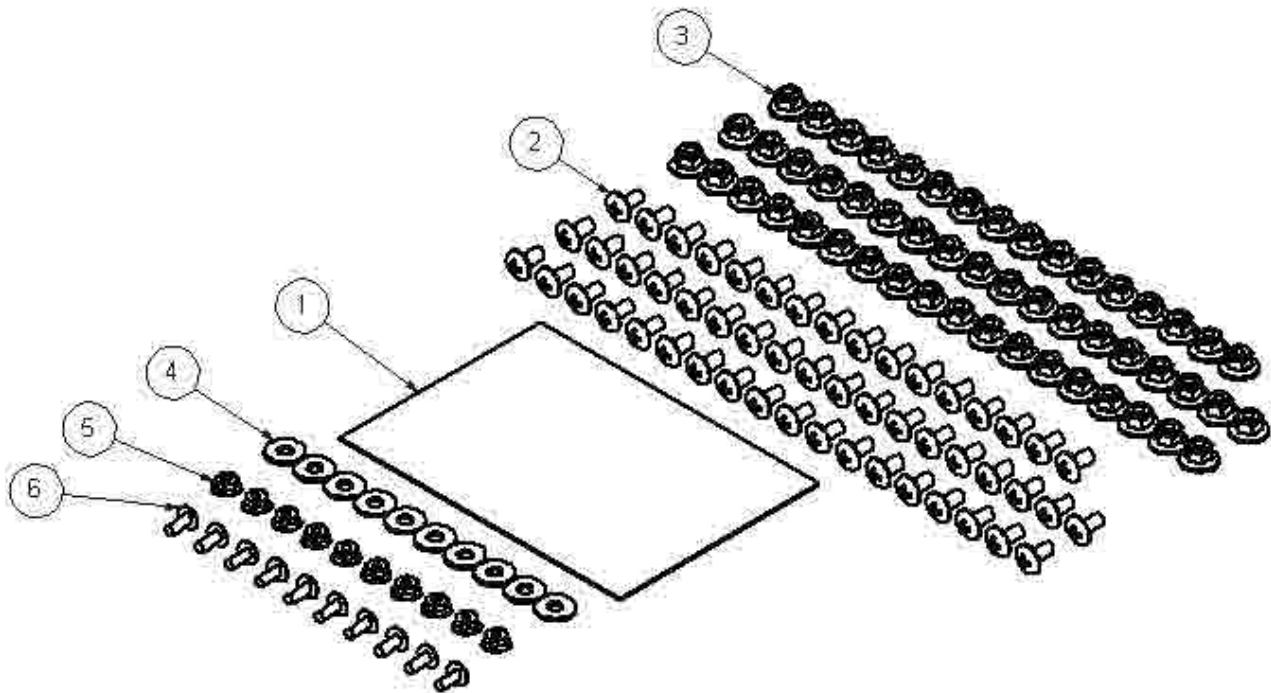





### Component Hardware Identification Sheets

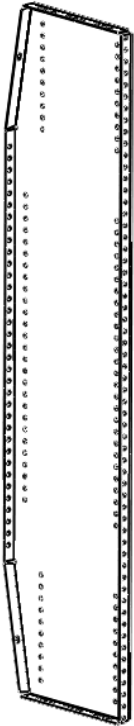

EP1459  
END PANEL, 14" X 59"  
Qty = 2  
**(HAD3459, HAD4459, HAD5059)**

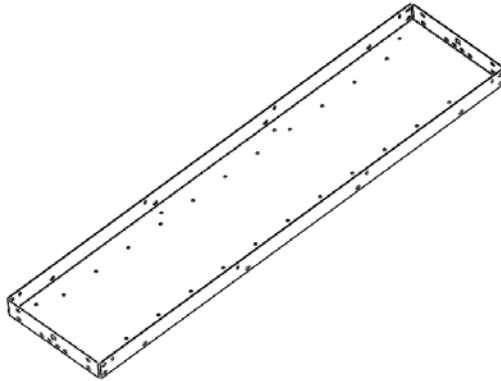

SF21250H-G (HAD5059)  
SF21244H-G (HAD4459)  
SF21232H-G (HAD3259)

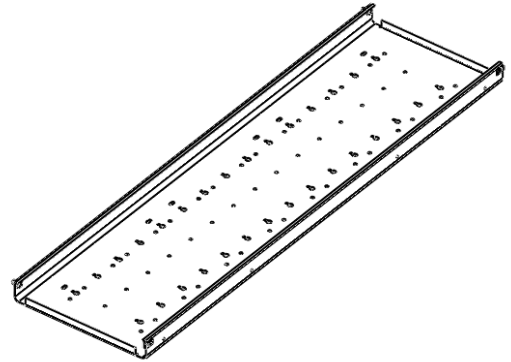

35328-G (HAD5059) QTY = 2  
35327-G (HAD4459) QTY = 2  
35325-G (HAD3259) QTY = 2

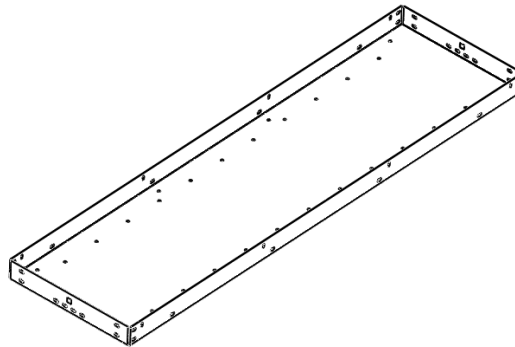

SF21450H-G (HAD5059)  
SF21444H-G (HAD4459)  
SF21432H-G (HAD3259)

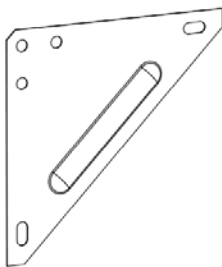

GS6X6  
GUSSET, 6 X 6  
Qty = 2  
**(HAD3459, HAD4459, HAD5059)**

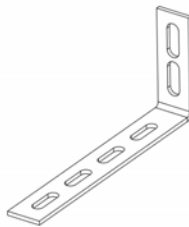

45739-G  
MTG BRACKET, END PANEL  
Qty = 2  
**(HAD3459, HAD4459, HAD5059)**

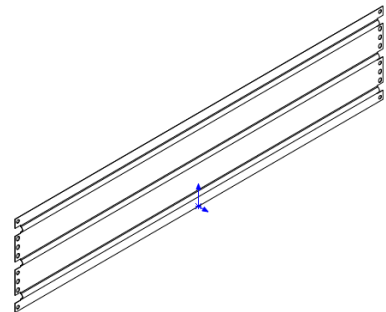

35319-G (HAD5059) Qty = 2  
35310-G (HAD4459) Qty = 2  
35318-G (HAD3259) Qty = 2

**STEP 1.0 End Panels to top and bottom shelves**

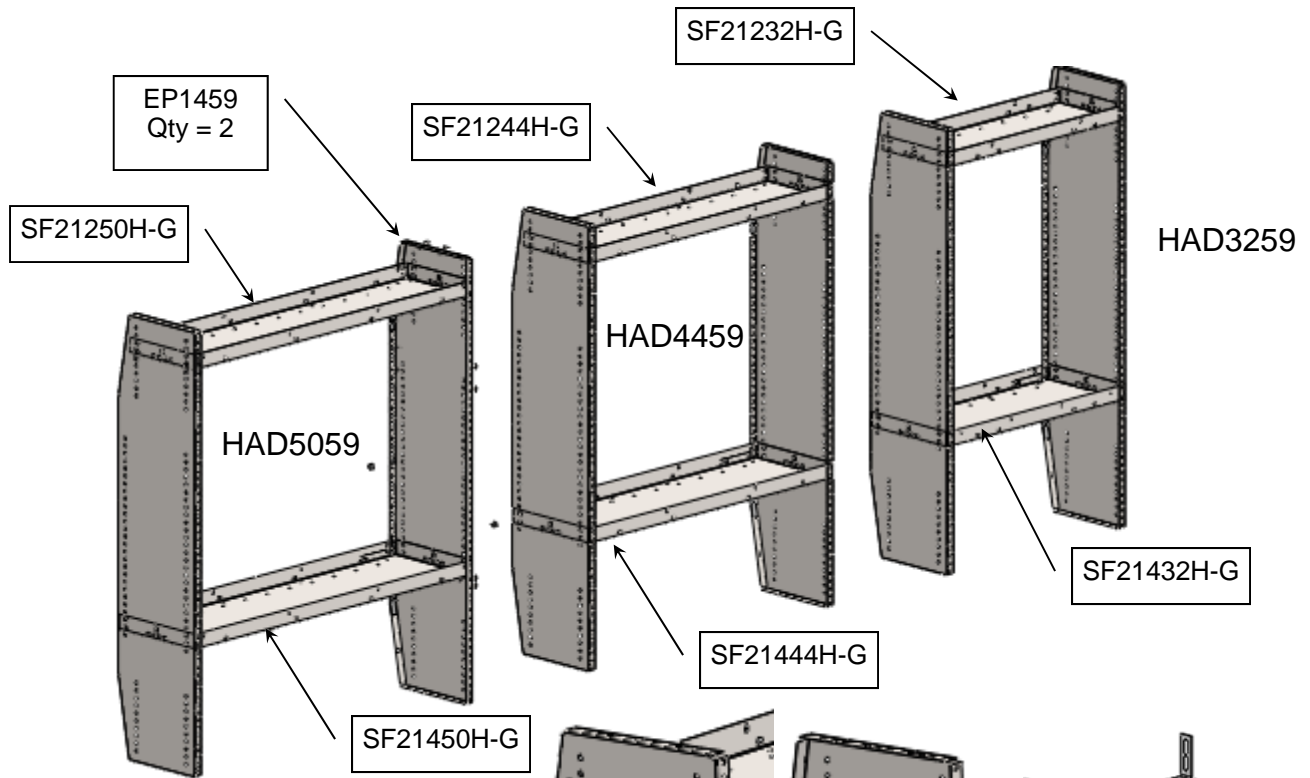

SECURE COMPONENTS  
USING THE FASTENERS LISTED  
BELOW AT LOCATIONS INDICATED  
IN BOTTOM LEFT DETAIL VIEWS

- FAS0061
- SCREW, THP, 1/4-20UNC X 1/2"
- FAS0055
- NUT, HEX, FLNG, 1/4-20UNC
- QTY = 24

OPTIONAL: FOR ADDING UTILITY  
HOOKS APPLY AND FASTEN AT  
INDICATED LOCATIONS

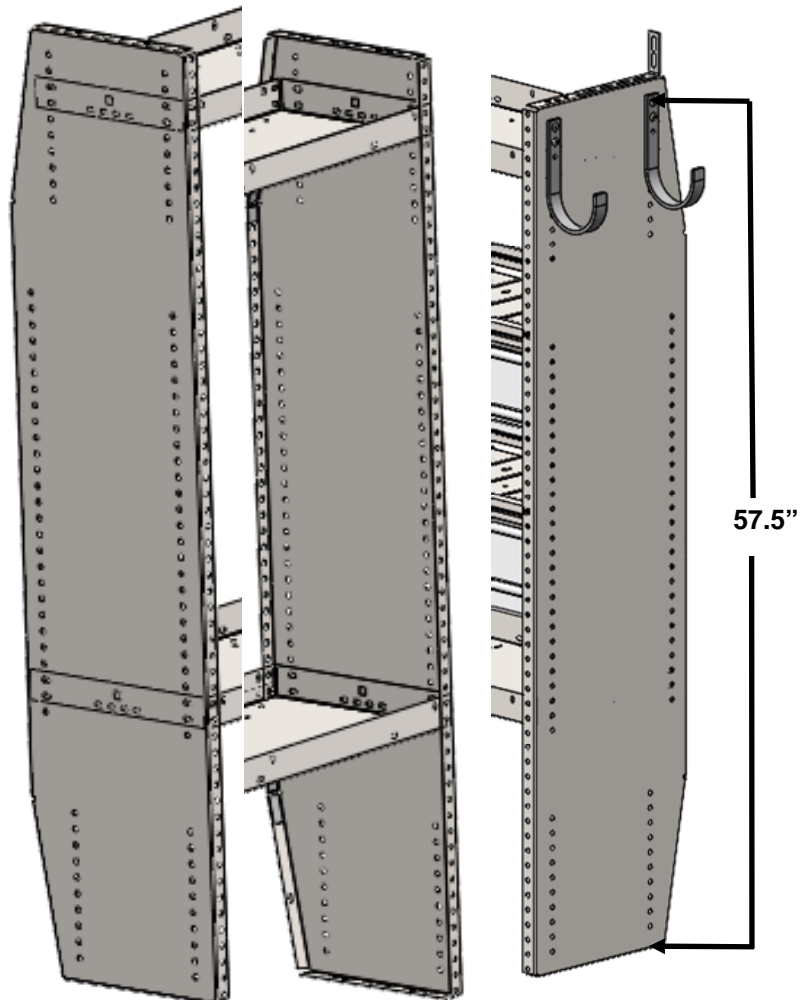
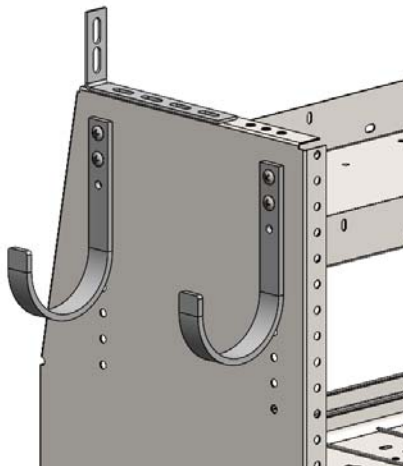

**STEP 2.0 "MIDDLE SHELVING TO END PANELS"**

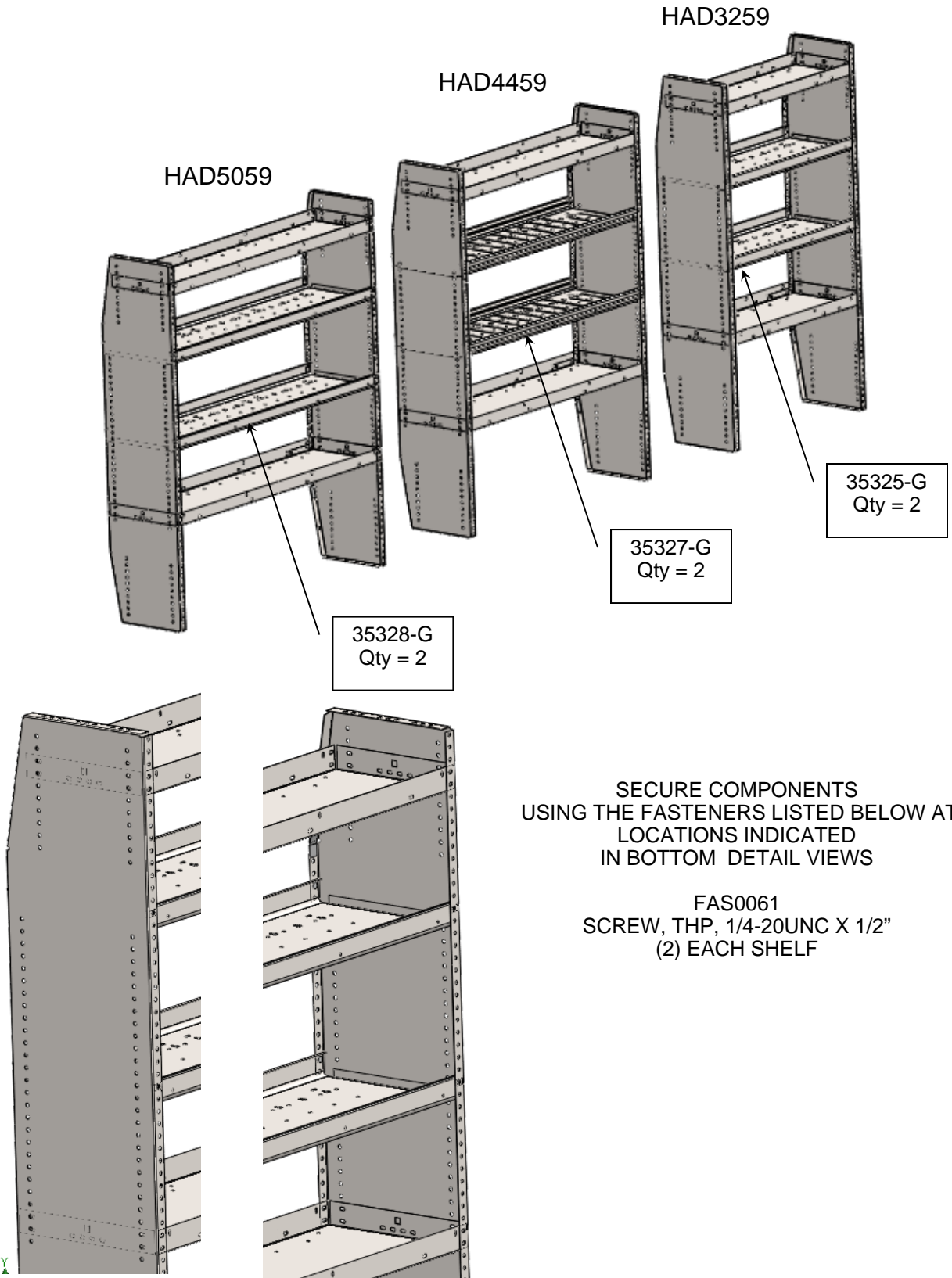

**STEP 3.0 "BACK PANELS AND GUSSETS TO END PANELS**

**\*\*PLEASE NOTE THESE GO ON DIFFERENT FROM OUR AD SERIES SHELVING.**

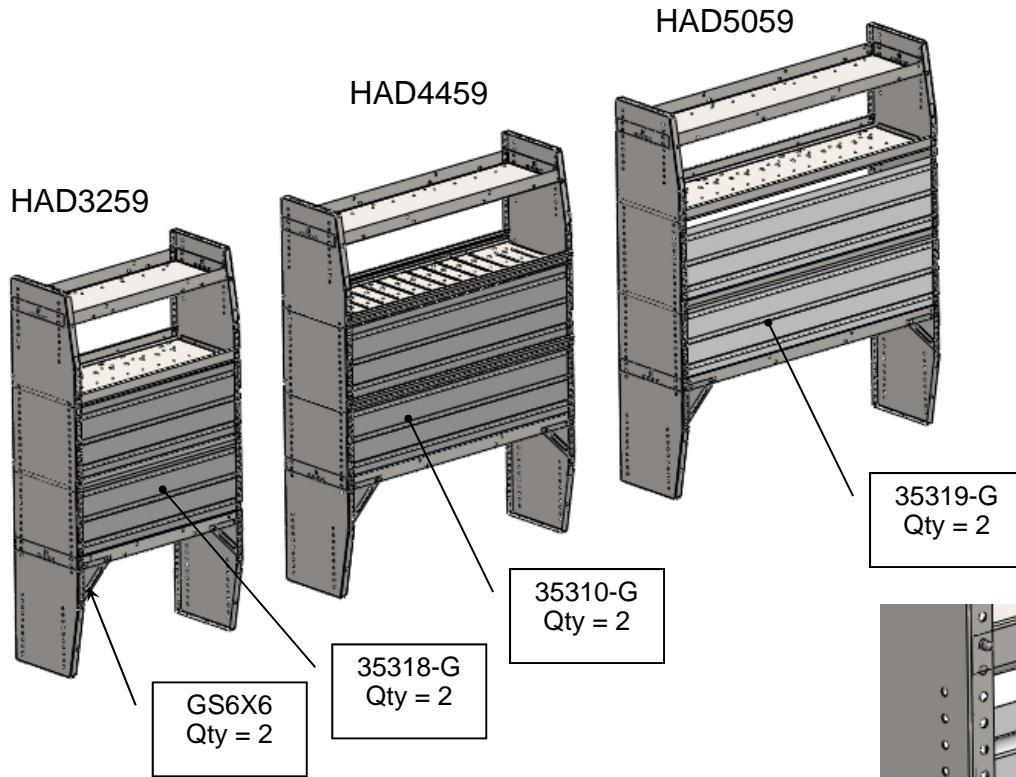

SECURE COMPONENTS  
USING THE FASTENERS LISTED BELOW  
AT LOCATIONS INDICATED  
IN BOTTOM DETAIL VIEWS.

FAS0061—SCREW, THP, 1/4-20UNC X 1/2"  
QTY = 6

FAS0055—NUT, HEX, FLNG, 1/4-20UNC.  
QTY = 6

FAS0712—RIVET AND WASHER ASM.  
QTY = 8

INSIDE END PANEL

**PLEASE NOTE THE  
ORIENTATION OF BACK  
PANEL. THE ROUND FORM  
GOES ON INSIDE OF END  
PANEL**

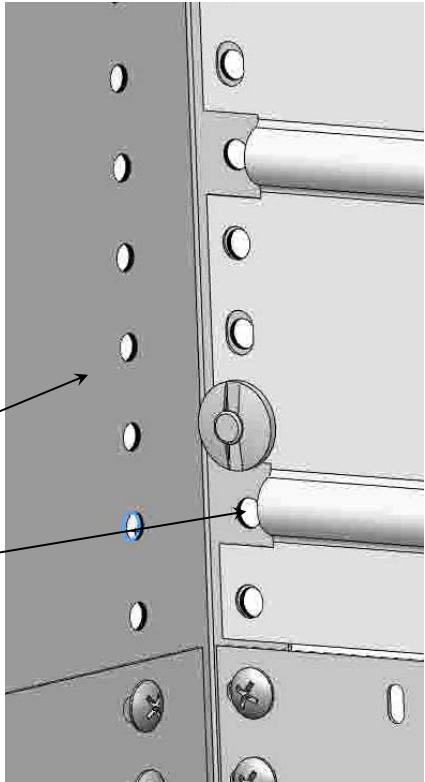

**STEP 4.0 "TYPICAL MOUNTING TO THE RAIL SYSTEM".** Move the KD unit close to the vehicle wall to maximize cargo space. The rail bolts should be tightened before the top mounting brackets can be tightened  
Fasteners listed below may be from the rail kit or the HADXX59 kit.

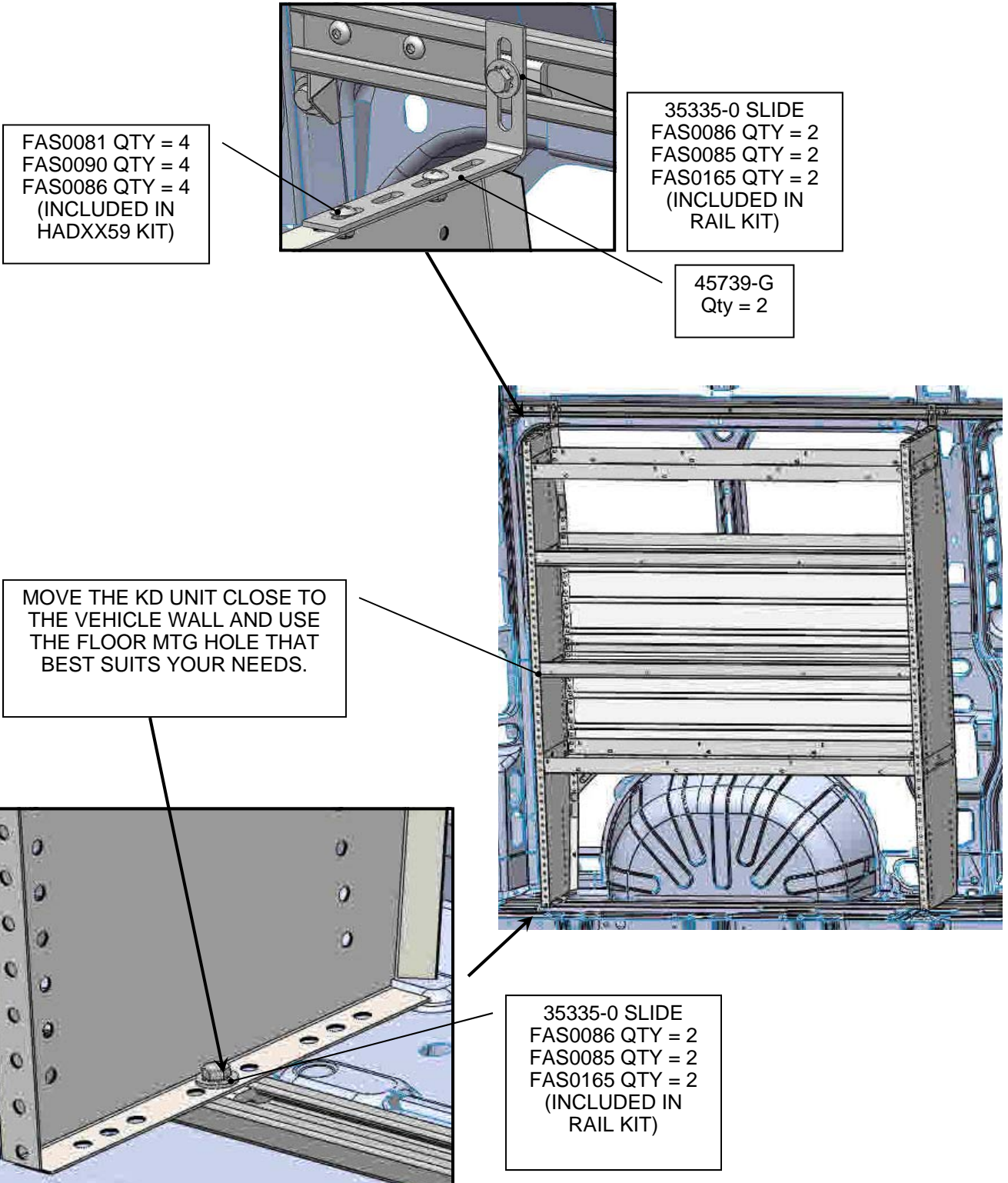

**STEP 5.0 "TYPICAL MOUNTING DIRECTLY TO VEHICLE".** Move the KD unit close to the vehicle wall to maximize cargo space. Attach Bracket to Shelving unit to engage (2) fastener locations.

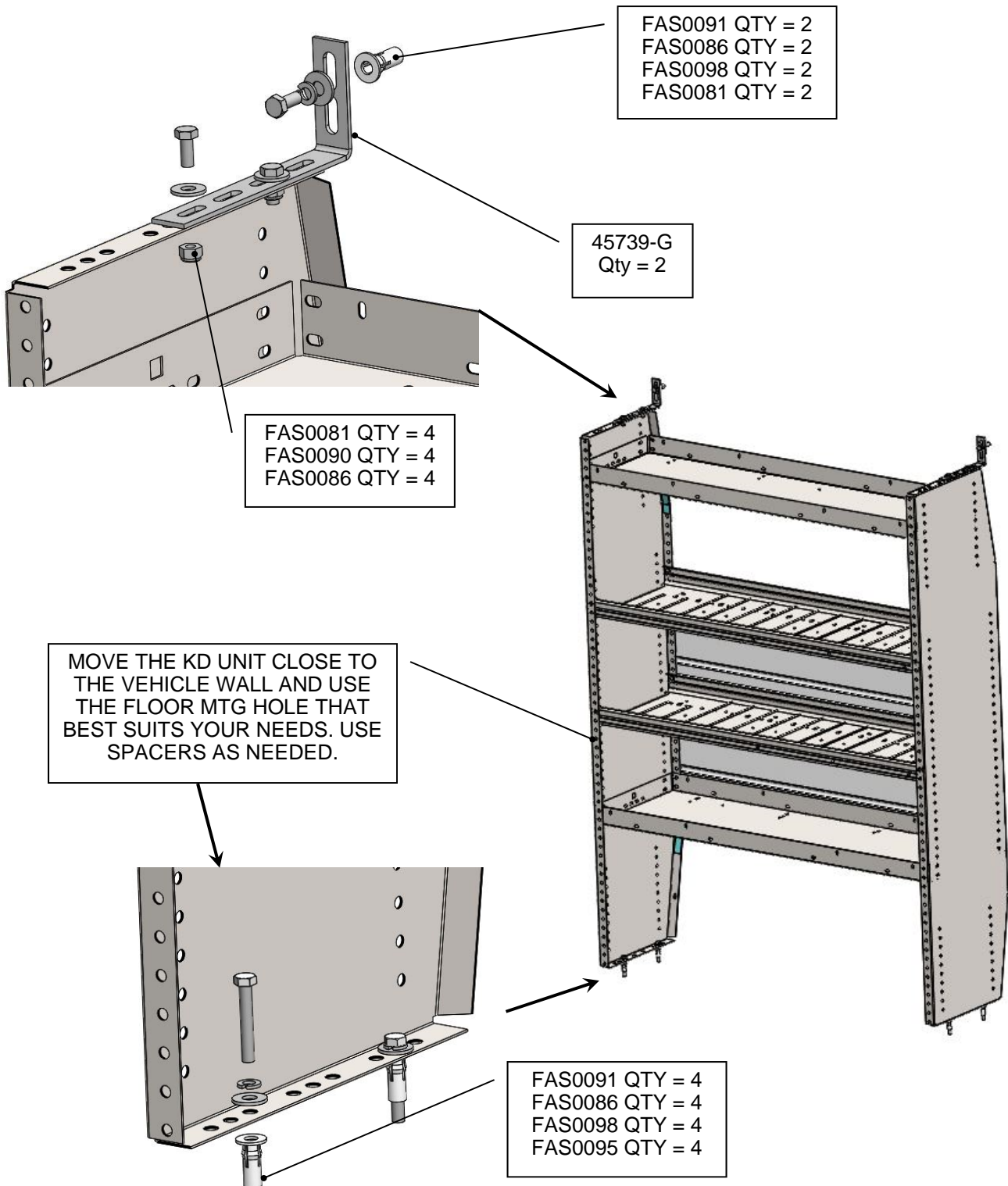

ALWAYS USE DRILL STOPS AND MAKE SURE YOU CHECK UNDER THE VEHICLE BEFORE DRILLING .  
ADDITIONAL BRACKETS CAN BE ADDED AT THE BELT LINE OF THE VEHICLE FOR EXTRA SUPPORT.



## YOUR INSTALLATION IS NOW COMPLETE

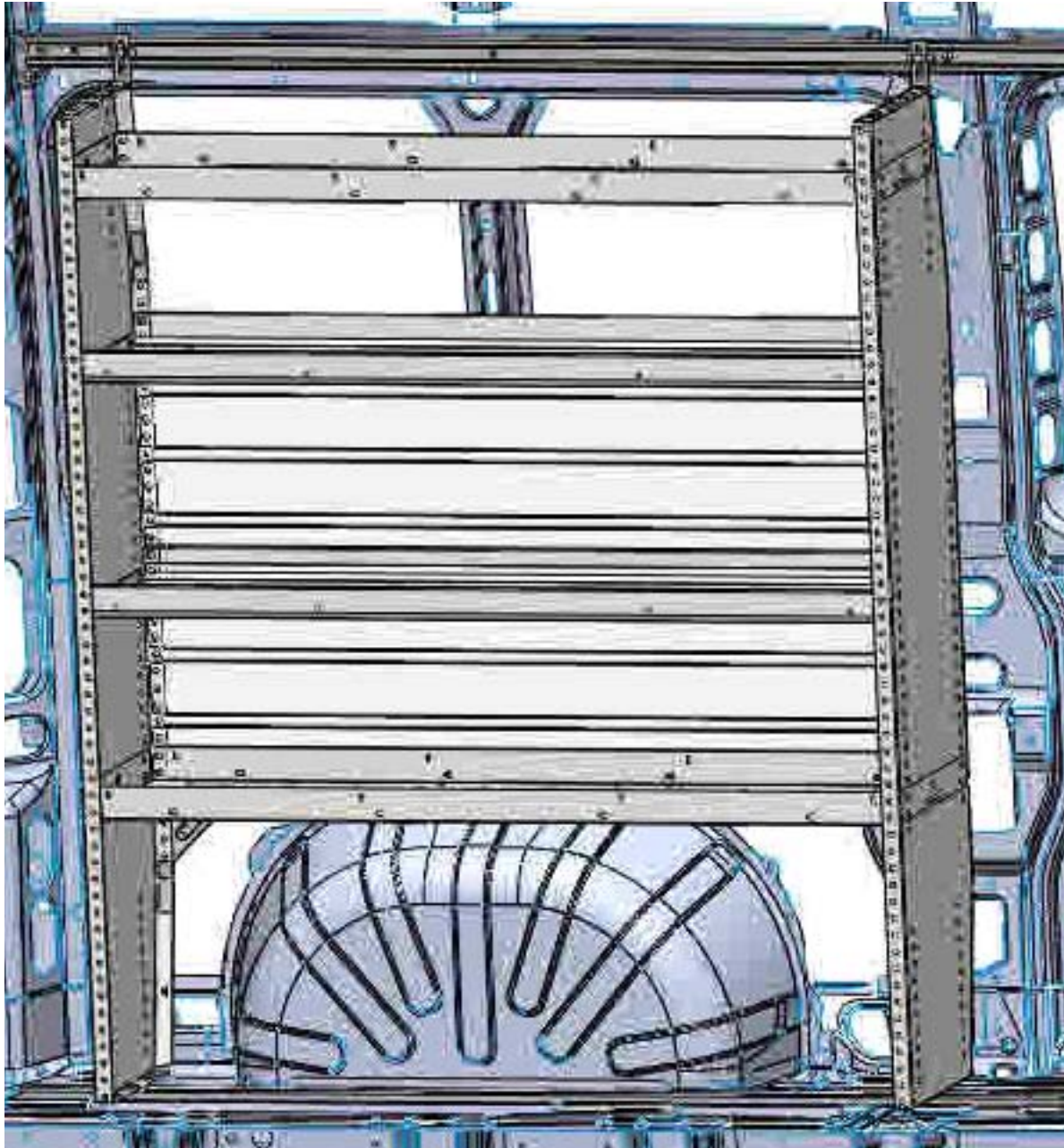

**DOUBLE CHECK ALL FASTENERS LOCATIONS TO BE SURE THAT ALL  
FASTENERS ARE TIGHTENED TO SPECIFICATIONS.  
YOUR INSTALLATION IS NOW COMPLETE!  
STOW THIS COPY IN THE VEHICLE FOR FUTURE REFERENCES!**



**Introduction / Comments:**

Knock Down Shelving for Medium/High roof vehicles. These units have tall end panels and use formed shelves at the top and bottom. The center shelves use the AD series style and are easily adjustable after installation.

**Note:**

It is advised that all fasteners used in this assembly and installation should be checked for tightness at the following intervals: @ 2-weeks and again @ 6-weeks of operation. This preventive maintenance step must be completed to ensure your Shelving gives you long service life.

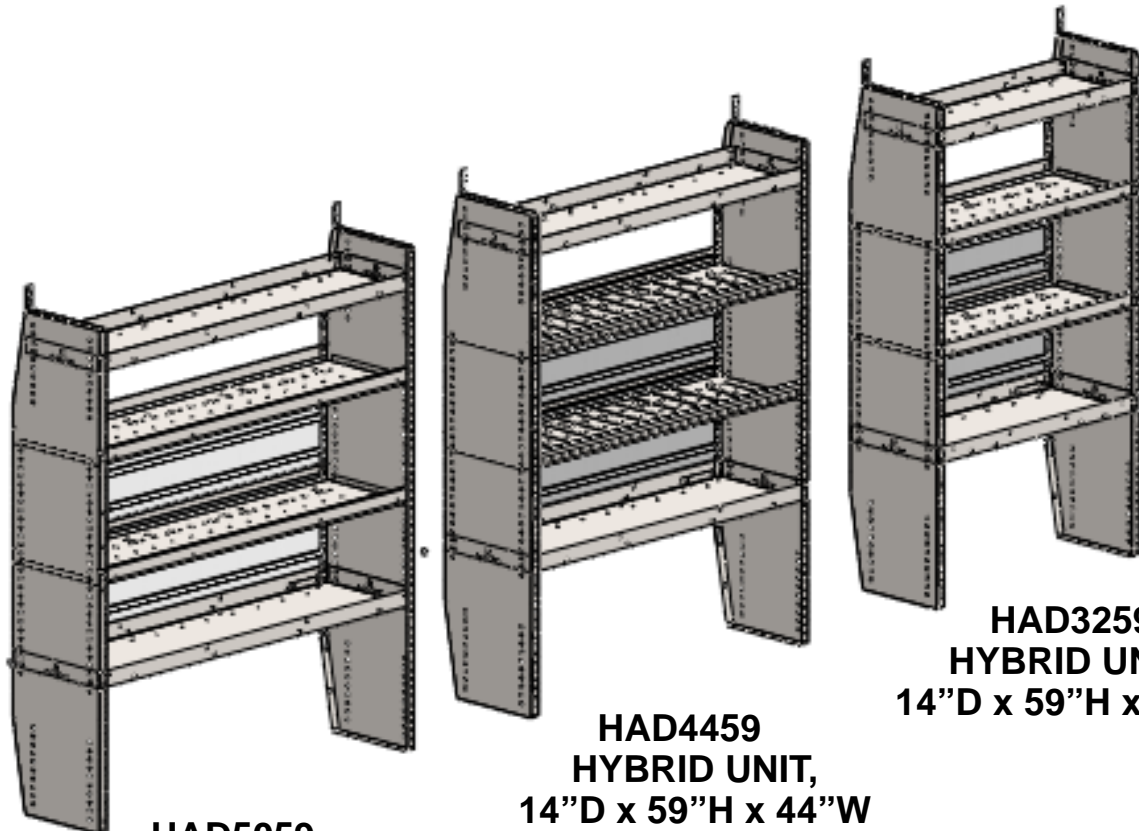

**HAD5059  
HYBRID UNIT,  
14”D x 59”H x 50”W**

**HAD4459  
HYBRID UNIT,  
14”D x 59”H x 44”W**

**HAD3259  
HYBRID UNIT,  
14”D x 59”H x 32”W**



## - PRECAUTIONS -





 **CAUTION**   
**THE USE OF AIR IMPACT TOOLS CAN  
OVER-TORQUE FASTENERS AND  
CAUSE FASTENER FAILURE!**



 **CAUTION**   
**ALL INSTALLATION HOLES SHOULD BE SEALED  
WITH SILICON OR BUTYL SEALANT TO PREVENT  
EXHAUST FUMES FROM ENTERING THE VEHICLE!**



 **DANGER**   
**INSPECT FOR FUEL TANK, FUEL LINES, BRAKE LINES, HIGH  
VOLTAGE BATTERIES AND ELECTRICAL LINES PRIOR TO  
DRILLING TO AVOID DAMAGING CRITICAL VEHICLE SYSTEMS  
OR INJURY TO INSTALLER DURING INSTALLATION PROCESS!**



 **CAUTION**   
**TO AVOID DAMAGING THE VEHICLE ALWAYS  
USE DRILL STOPS WHEN DRILLING ANY IN-  
STALLATION HOLES!**



## - IMPORTANT WARRANTY REQUIREMENTS -

1. SUBSTITUTING ADRIAN STEEL SPECIFIED FASTENERS FOR ASSEMBLY AND/OR INSTALLATION WILL VOID YOUR PRODUCT WARRANTY.
2. ALL HOLES DRILLED INTO VEHICLE SHOULD HAVE THE RAW METAL EDGES SEALED WITH A SELF-ETCHING PRIMER TO RESIST CORROSION AND POTENTIAL FASTENER POINT FAILURE.
3. ALL FASTENERS USED IN THE INSTALLATION OF THIS PRODUCT SHOULD BE TIGHTENED TO THE TORQUE(S) SPECIFIED IN THESE INSTRUCTIONS.
4. THESE INSTRUCTIONS SHOULD BE KEPT WITH THE VEHICLE.

### THE BASIC TOOLS NEEDED FOR MOST INSTALLATIONS



DRILL



DRILL BIT WITH  
STOP



RATCHET, SOCKETS  
AND/OR WRENCHES



SCREWDRIVERS



MEASURING TAPE

ADDITIONAL TOOLS MAY BE NEEDED FOR THIS INSTALLATION AND THEY WILL BE IDENTIFIED IN THE STEPS THAT FOLLOW.

If your vehicle contains carpet or a rubber floor mat you will need to prepare the mounting location. Position the product to be installed into the vehicle and once you are satisfied with the mounting locations, mark the mounting locations. Using a 1-3/16" diameter carpet cutter (P/N: 31183-0). Select the appropriate floor spacers as shown in the illustration. Set those aside for use later into the installation process. Using the correct drill bit size for the selected plusnut, drill the mounting holes in the vehicle sheet metal to prepare for installing the plusnuts. If you are thru-bolting at any of the locations simply drill a hole that is 1/16" larger than the bolt size(s) for those locations. Once you have drilled the holes into the vehicle, the raw metal edges should be sealed using a self-etching primer to resist corrosion and potential fastener point failure.

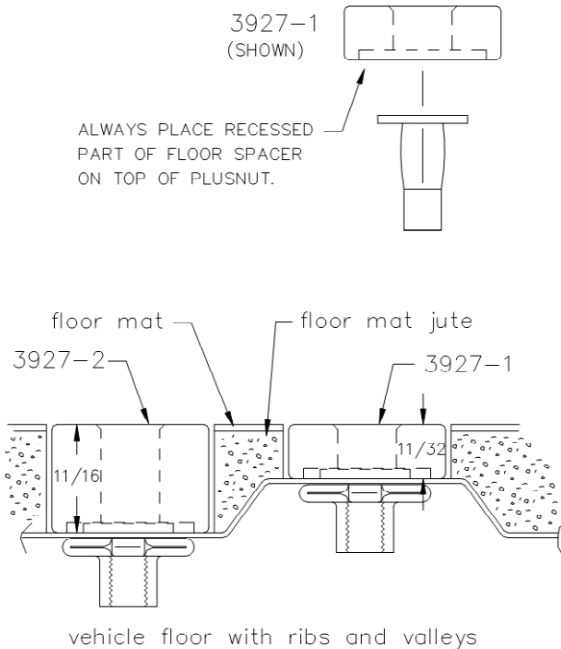

A PLUSNUT (RIVNUT) SETTING TOOL IS REQUIRED FOR PLUSNUT (RIVNUT) INSTALLATION AND IS SUPPLIED WITH THIS KIT. OR USE AN AIR POWERED PLUSNUT SETTING GUN.

1/4-20UNC Plusnut (FAS0052) Use 3/8" dia. drill w/stop  
 FAS0080 SCREW, HXHD, 1/4-20UNCx2.00", G8  
 FAS0067 WASHER, FLAT, 1/4"ID  
 22200-0 PLUSNUT TOOL

5/16-18UNC Plusnut (FAS0091) Use 1/2" dia. drill w/stop  
 FAS0095 SCREW, HXHD, 5/16-18UNCx2.00", G8  
 FAS0086 WASHER, FLAT, 5/16"ID  
 22200-0 PLUSNUT TOOL

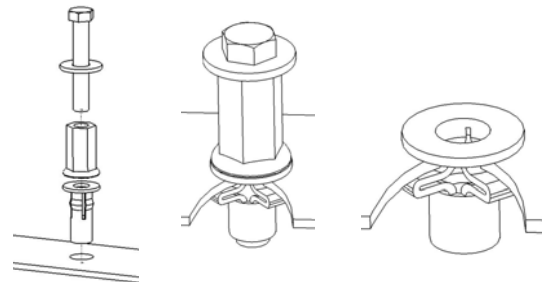

Place barrel of the plusnut body in sheet metal thru hole until flange is flush with sheet metal. Using a 9/16" combination wrench of plusnut tool body and a second hand wrench, ratchet, or air tool, rotate the hex bolt head CW to draw plus nut flanges up (set the plusnut).

## Assembly and Installation Fastener Identification Sheet ( BAGADXXFP )

ITEM NO.	PART NUMBER	DESCRIPTION	BAGADXXFP/QTY.
1	BAG0406-A	4" X 6" 3MIL AUTOBAG	1
2	FAS0061	Screw, Truss Hd. Ph, 1/4-20x0.50	6
3	FAS0712	RIVET AND WASHER ASSEMBLY	12

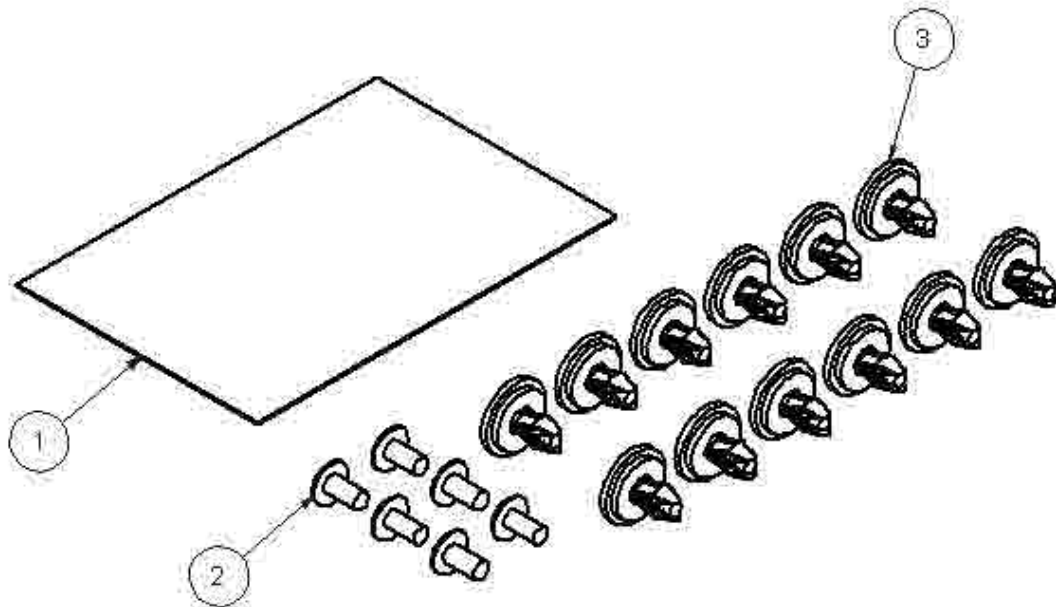

### Assembly and Installation Fastener Identification Sheet (BAGHADINST)

A1	PART NUMBER	DESCRIPTION	BAGHADINST/QTY.
1	FAS0091	Plusnut, 5/16	6
2	FAS0098	Washer, Lock, Split, 5/16, Zinc Plate	6
3	FAS0086	WASHER,FLAT USS 5/16 ZP	10
4	BAG0507-A	5" x 7" 3MIL AUTOBAG	1
5	FAS0090	Nut, Nylon Insert Lock, 5/16-18, Zi	4
6	FAS0081	Screw, Hex Hd, 5/16-18x0.75 Zn Plate	6
7	03927-2	Tall Floor Spacer	4
8	03927-1	Floor Spacer Short	4
9	FAS0095	Screw, Hex Hd, 5/16-18x2.00 , Grade 8	4
10	22200-0	Plus Nut tool	1

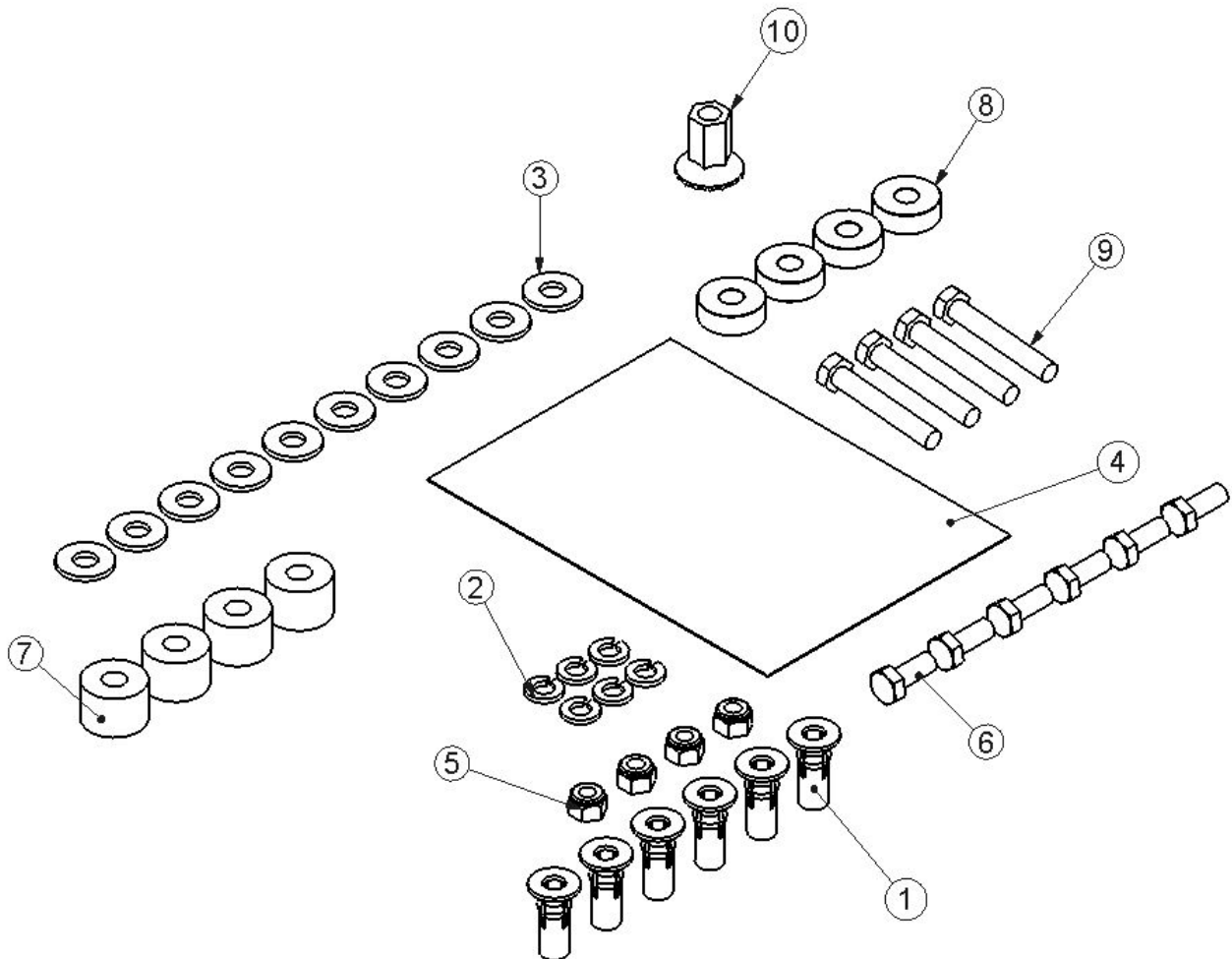

## Assembly and Installation Fastener Identification Sheet ( BAG00046-0 )

ITEM NO.	PART NUMBER	DESCRIPTION	QTY
1	BAG0507-A	5" x 7" 3MIL AUTOBAG	1
2	FAS0061	Screw, Truss Hd. Ph, 1/4-20x0.50	52
3	FAS0055	Nut, Hex Flange, Nylock 1/4-20	52
4	FAS0067	Washer, Flat, 1/4	10
5	FAS0020	Nut, Hex Flange, #10-24	10
6	FAS0025	Screw, Truss Hd. Ph, #10-24x0.50	10

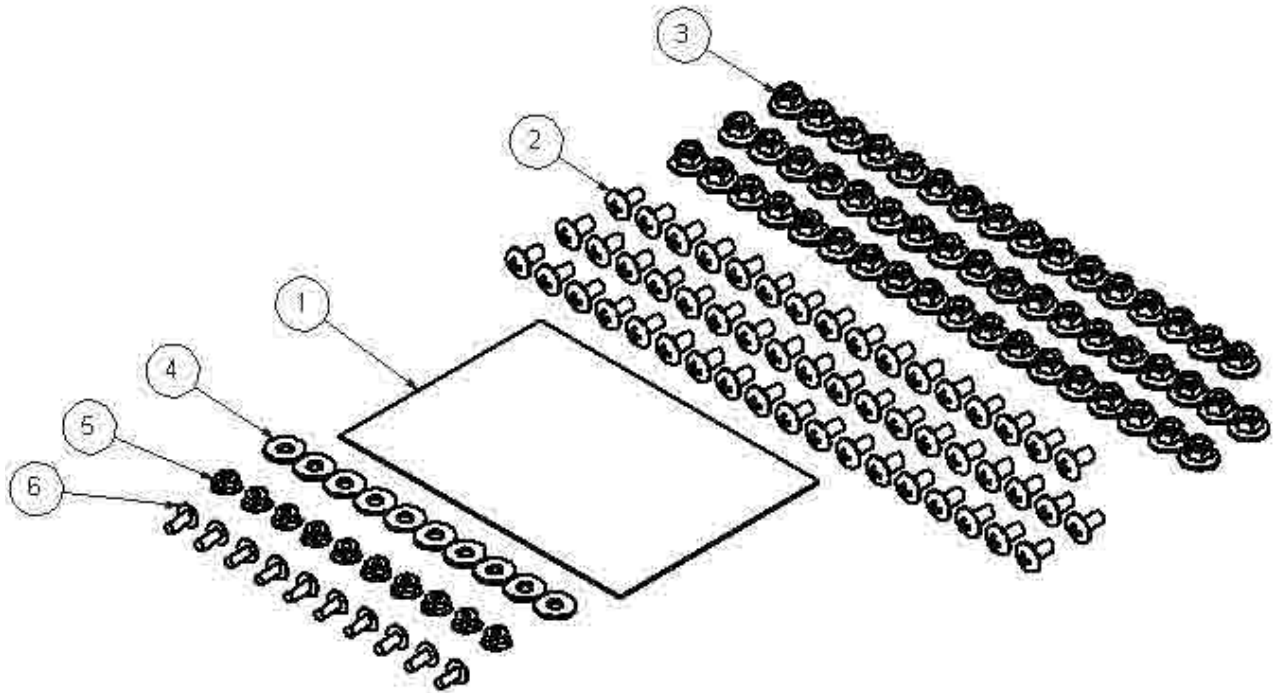



### Component Hardware Identification Sheets

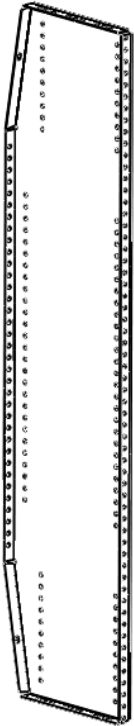

EP1459  
END PANEL, 14" X 59"  
Qty = 2  
(HAD3459, HAD4459, HAD5059)

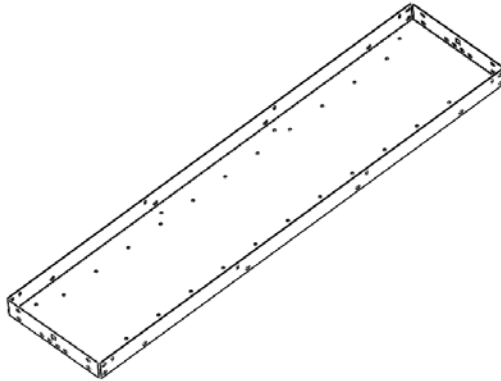

SF21250H-G (HAD5059)  
SF21244H-G (HAD4459)  
SF21232H-G (HAD3259)

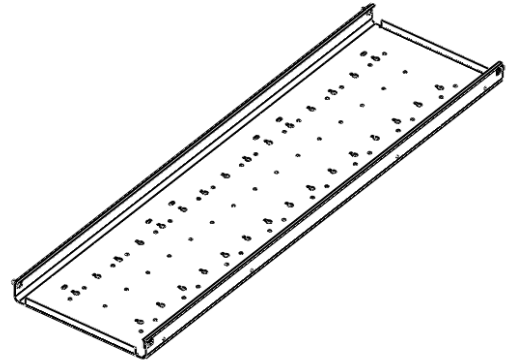

35328-G (HAD5059) QTY = 2  
35327-G (HAD4459) QTY = 2  
35325-G (HAD3259) QTY = 2

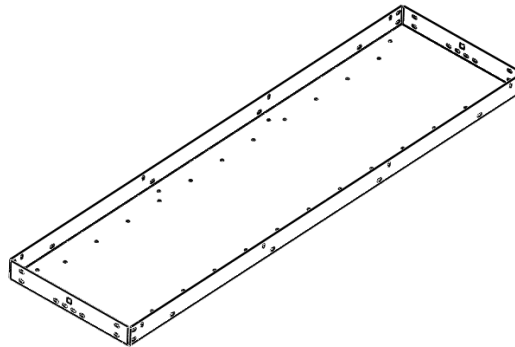

SF21450H-G (HAD5059)  
SF21444H-G (HAD4459)  
SF21432H-G (HAD3259)

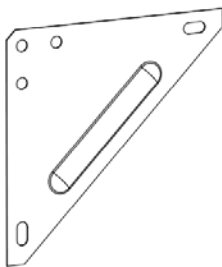

GS6X6  
GUSSET, 6 X 6  
Qty = 2  
(HAD3459, HAD4459, HAD5059)

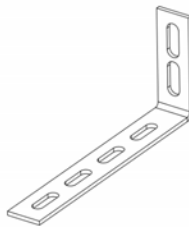

45739-G  
MTG BRACKET, END PANEL  
Qty = 2  
(HAD3459, HAD4459, HAD5059)

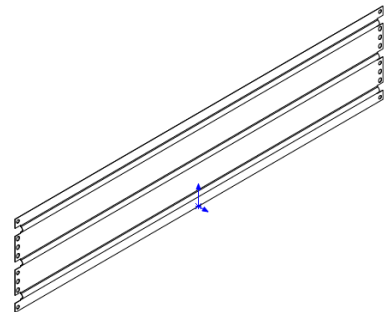

35319-G (HAD5059) Qty = 2  
35310-G (HAD4459) Qty = 2  
35318-G (HAD3259) Qty = 2

**STEP 1.0 End Panels to top and bottom shelves**

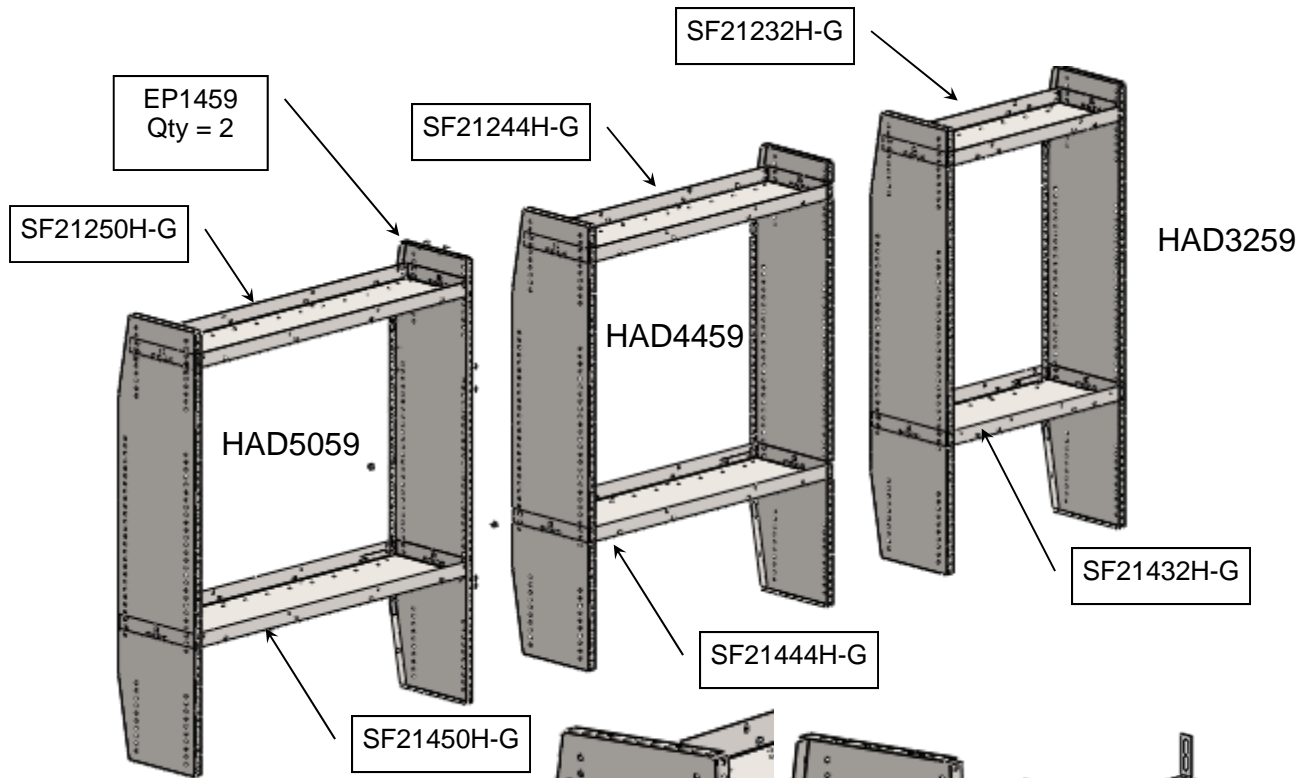

SECURE COMPONENTS  
USING THE FASTENERS LISTED  
BELOW AT LOCATIONS INDICATED  
IN BOTTOM LEFT DETAIL VIEWS

- FAS0061  
SCREW, THP, 1/4-20UNC X 1/2"
- FAS0055  
NUT, HEX, FLNG, 1/4-20UNC  
QTY = 24

OPTIONAL: FOR ADDING UTILITY  
HOOKS APPLY AND FASTEN AT  
INDICATED LOCATIONS

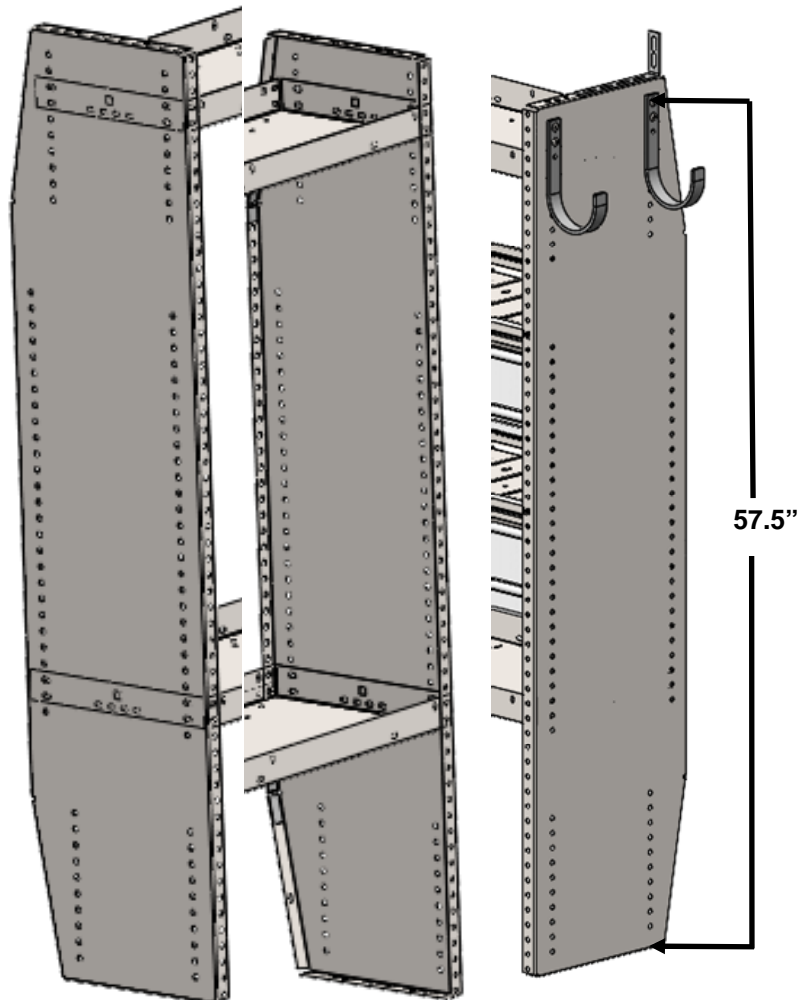
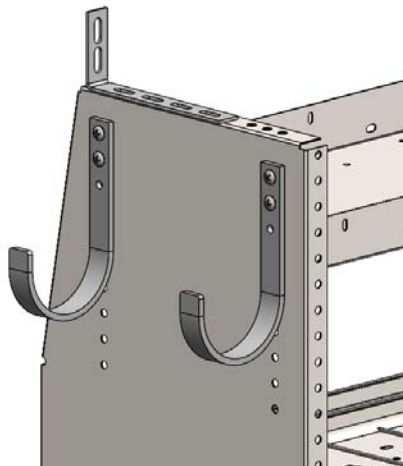

**STEP 2.0 "MIDDLE SHELVING TO END PANELS"**

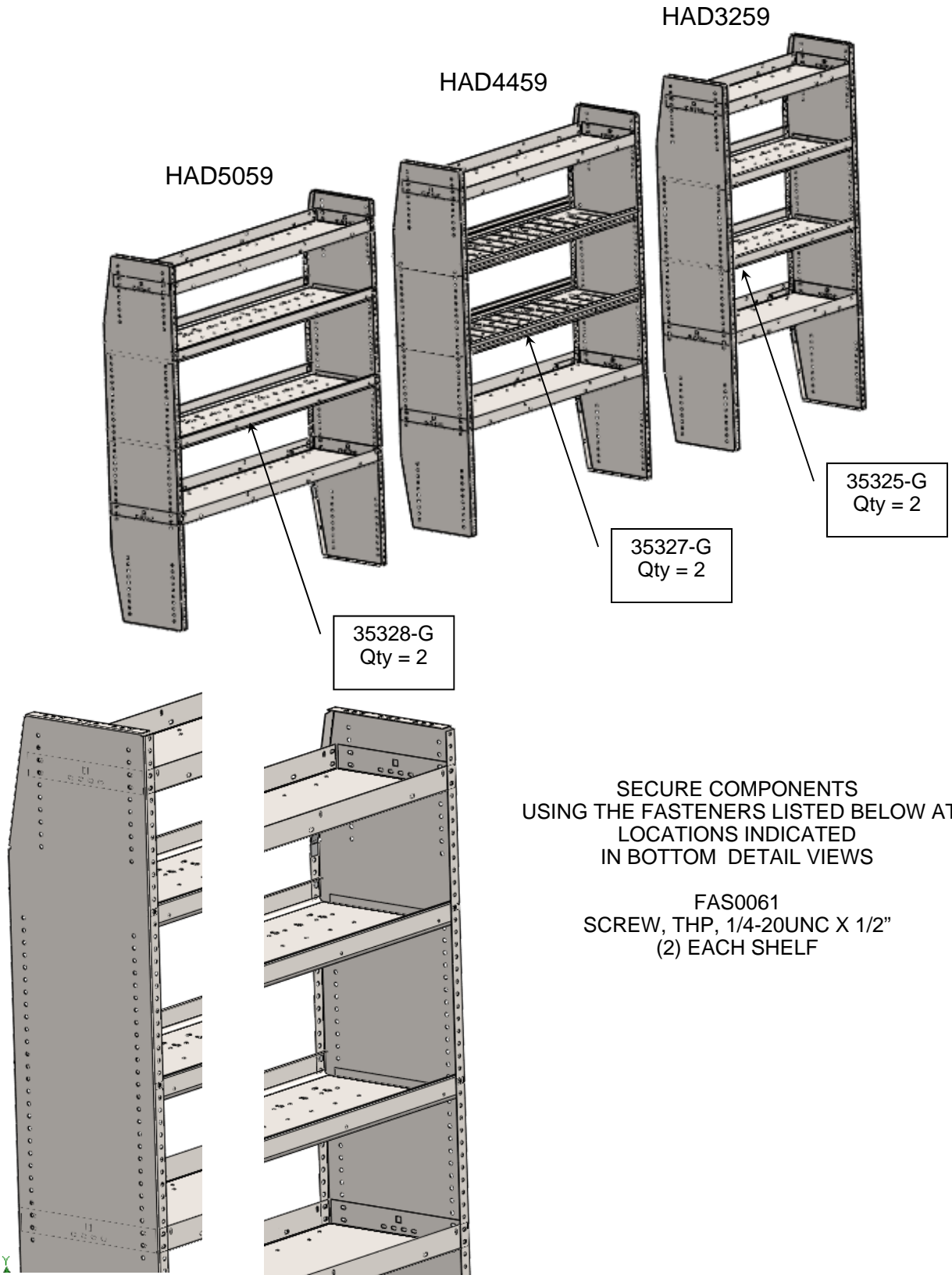



**STEP 3.0 "BACK PANELS AND GUSSETS TO END PANELS**

**\*\*PLEASE NOTE THESE GO ON DIFFERENT FROM OUR AD SERIES SHELVING.**

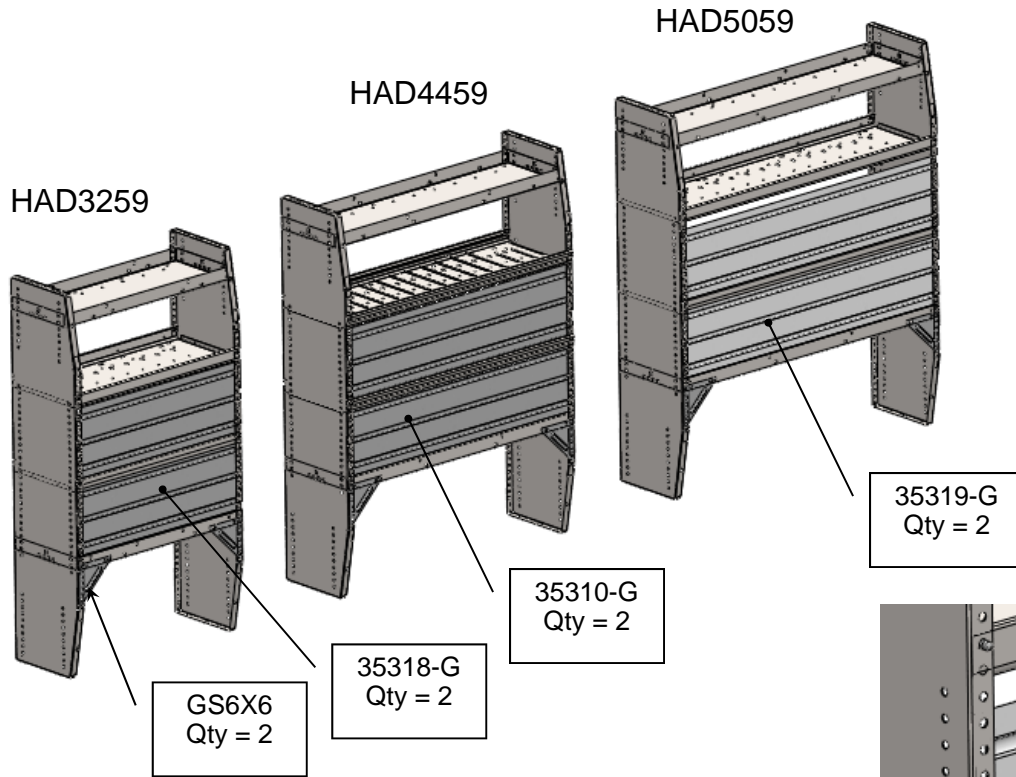

SECURE COMPONENTS  
USING THE FASTENERS LISTED BELOW  
AT LOCATIONS INDICATED  
IN BOTTOM DETAIL VIEWS.

FAS0061—SCREW, THP, 1/4-20UNC X 1/2"  
QTY = 6

FAS0055—NUT, HEX, FLNG, 1/4-20UNC.  
QTY = 6

FAS0712—RIVET AND WASHER ASM.  
QTY = 8

INSIDE END PANEL

**PLEASE NOTE THE  
ORIENTATION OF BACK  
PANEL. THE ROUND FORM  
GOES ON INSIDE OF END  
PANEL**

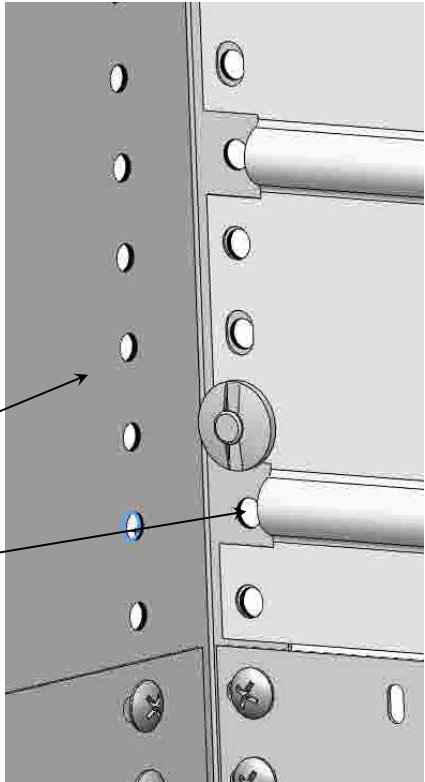

**STEP 4.0 "TYPICAL MOUNTING TO THE RAIL SYSTEM".** Move the KD unit close to the vehicle wall to maximize cargo space. The rail bolts should be tightened before the top mounting brackets can be tightened  
Fasteners listed below may be from the rail kit or the HADXX59 kit.

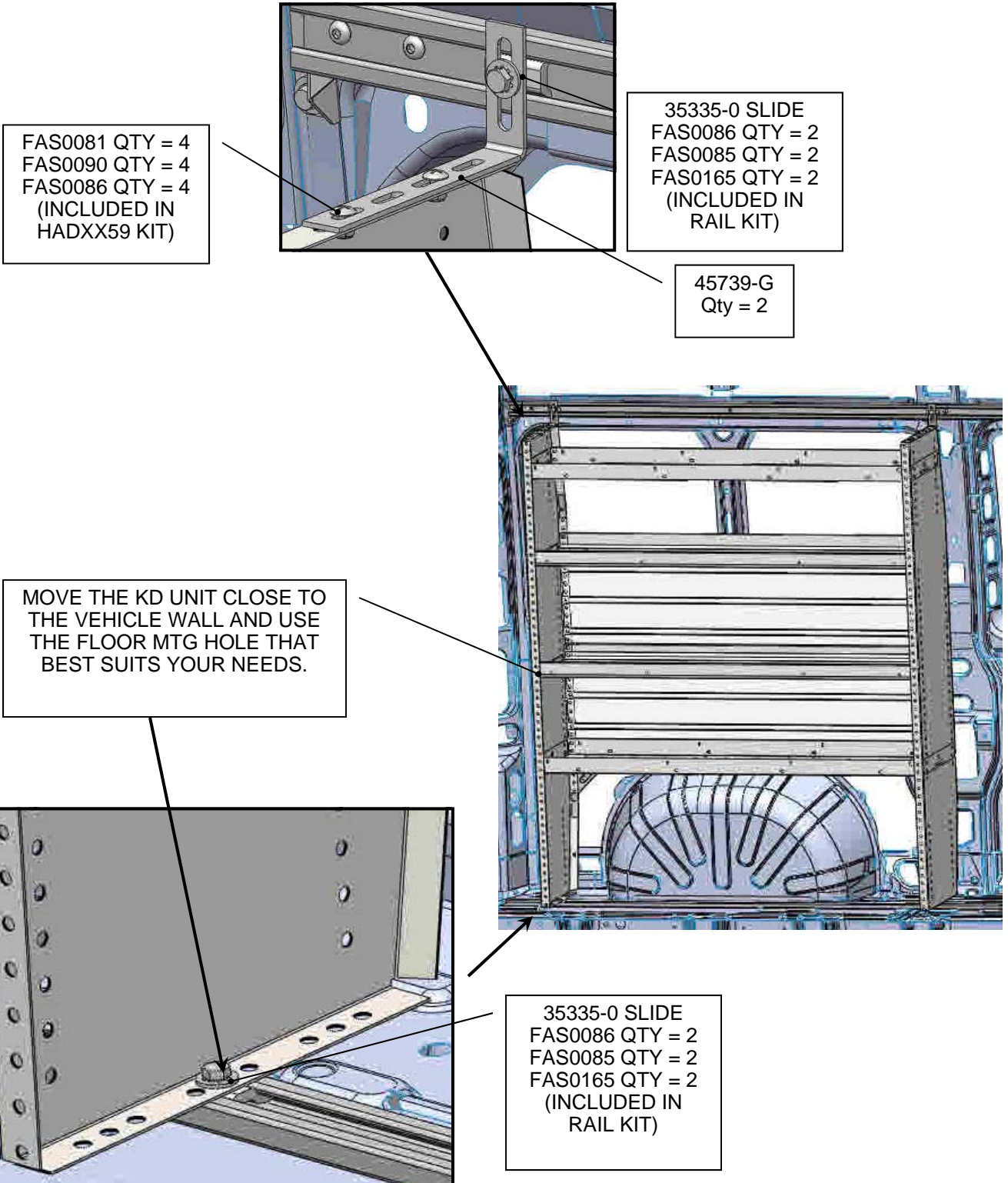

**STEP 5.0 "TYPICAL MOUNTING DIRECTLY TO VEHICLE".** Move the KD unit close to the vehicle wall to maximize cargo space. Attach Bracket to Shelving unit to engage (2) fastener locations.

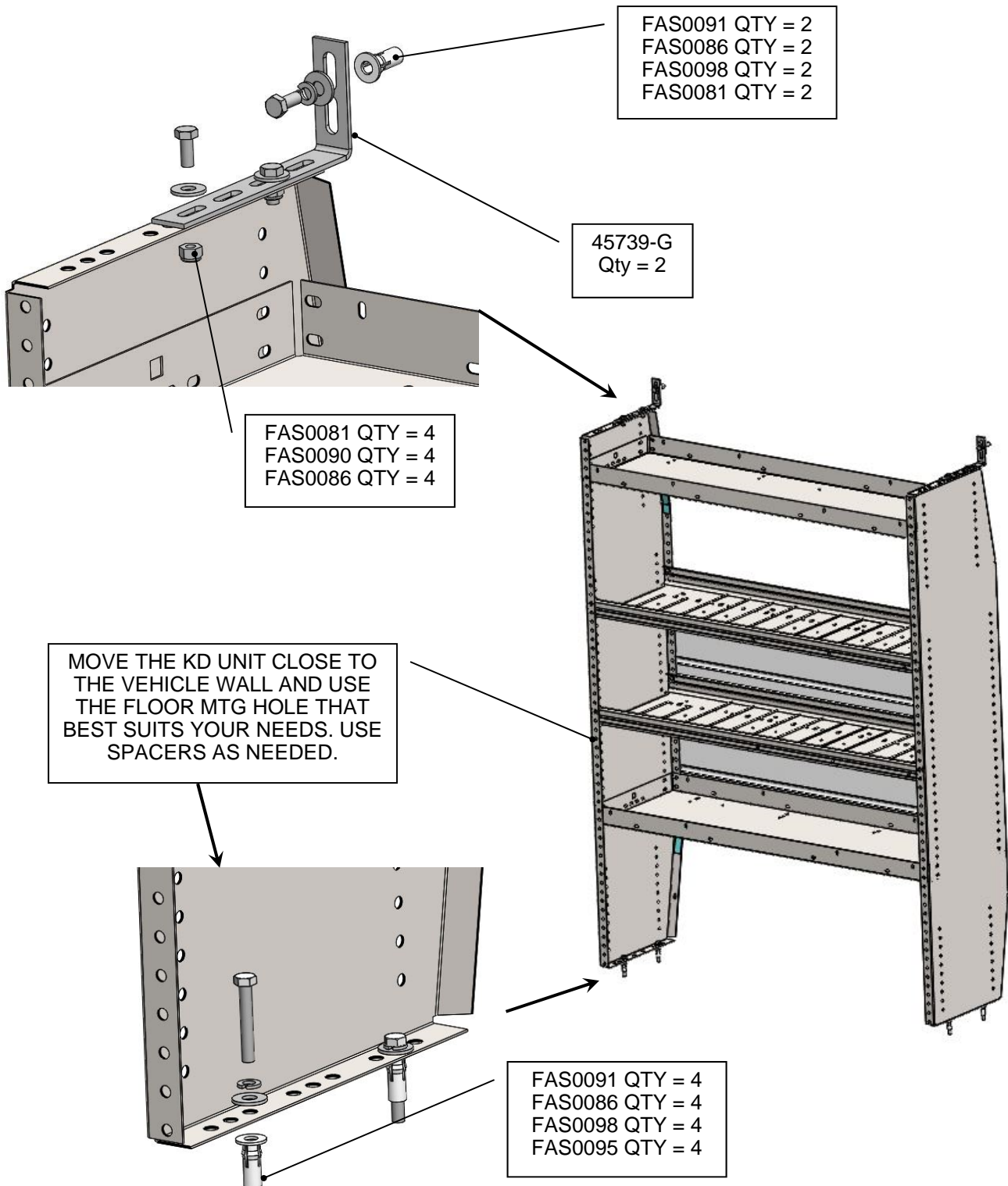

ALWAYS USE DRILL STOPS AND MAKE SURE YOU CHECK UNDER THE VEHICLE BEFORE DRILLING .  
ADDITIONAL BRACKETS CAN BE ADDED AT THE BELT LINE OF THE VEHICLE FOR EXTRA SUPPORT.



## YOUR INSTALLATION IS NOW COMPLETE

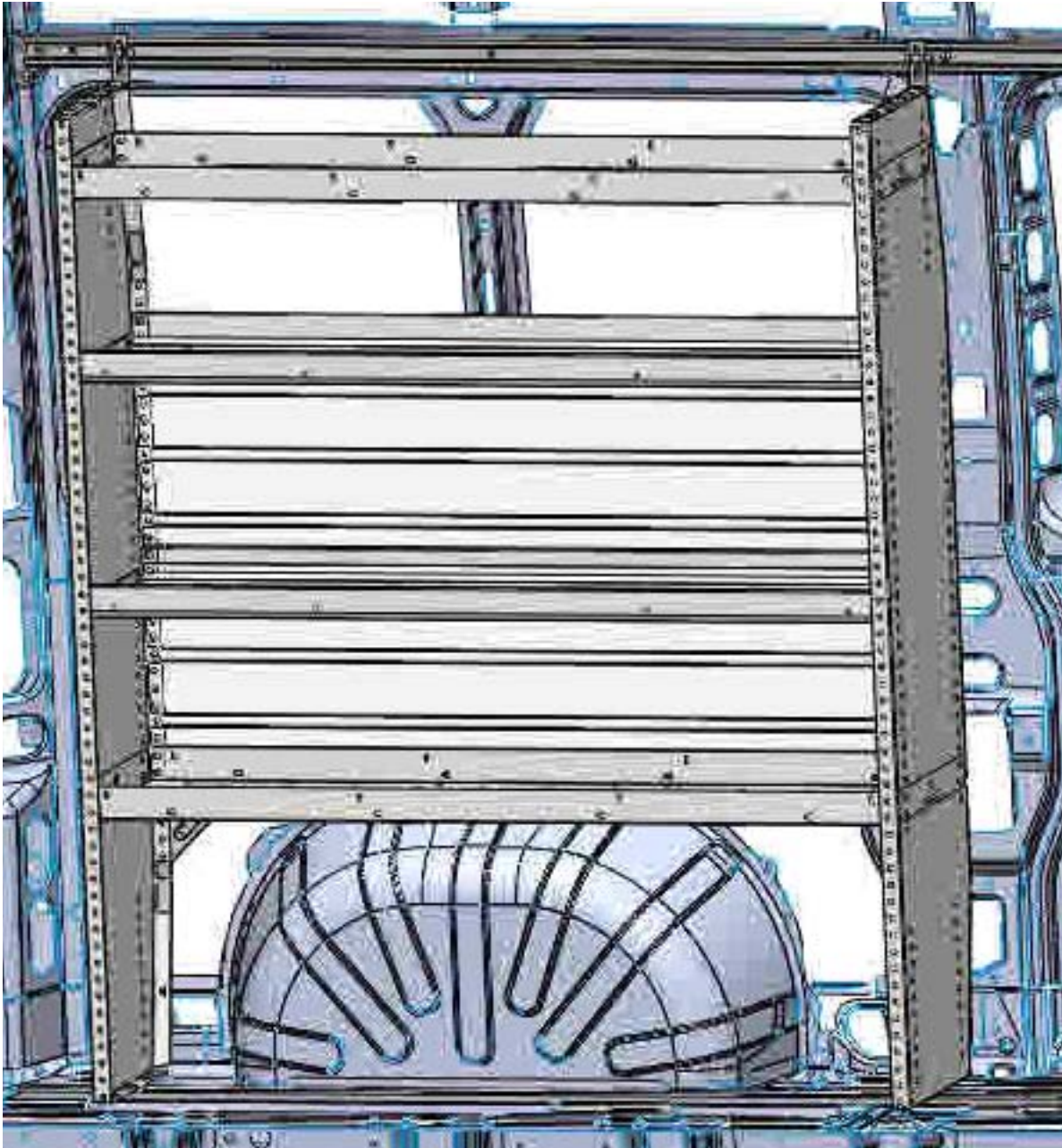

**DOUBLE CHECK ALL FASTENERS LOCATIONS TO BE SURE THAT ALL  
FASTENERS ARE TIGHTENED TO SPECIFICATIONS.  
YOUR INSTALLATION IS NOW COMPLETE!  
STOW THIS COPY IN THE VEHICLE FOR FUTURE REFERENCES!**