



ADRIAN STEEL®

Cargo Management Solutions for Commercial Vehicles

Assembly/Installation Instructions and Owners Manual

ITEM NO.	PART NUMBER	DESCRIPTION	QTY.
1	62646-B	SPR REAR STEP LH BRKT	1
2	62647-B	SPR REAR STEP RH BRKT	1
3	62650-B	SPR REAR STEP TOP ASSY	1

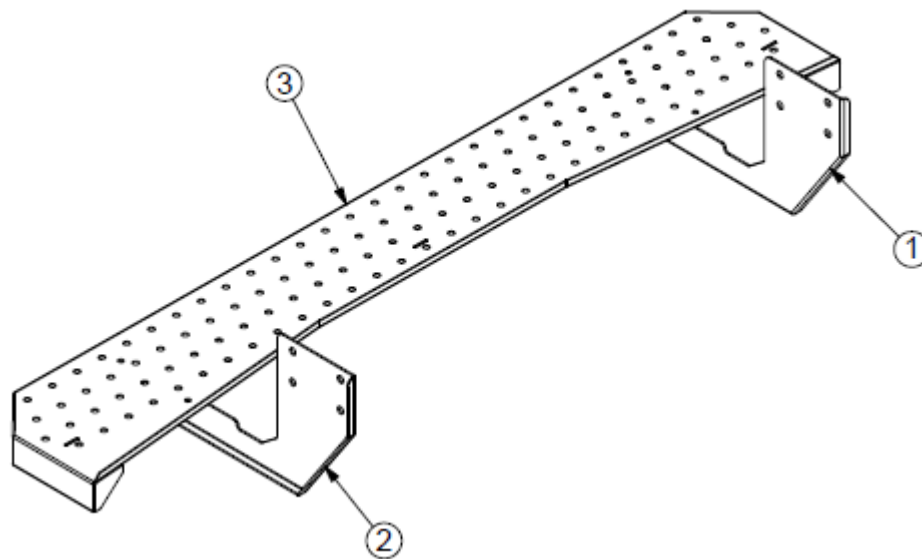

STEPSPRRD STEP, REAR, SPRINTER

- PRECAUTIONS -





 **CAUTION** 
**THE USE AIR IMPACT TOOLS CAN
OVER-TORQUE FASTENERS AND
CAUSE FASTENER FAILURE!**



 **CAUTION** 
**ALL INSTALLATION HOLES SHOULD BE SEALED
WITH SILICON OR BUTYL SEALANT TO PREVENT
EXHAUST FUMES FROM ENTERING THE VEHICLE!**



 **DANGER** 
**INSPECT FOR FUEL TANK, FUEL LINES, BRAKE LINES, HIGH
VOLTAGE BATTERIES AND ELECTRICAL LINES PRIOR TO
DRILLING TO AVOID DAMAGING CRITICAL VEHICLE SYSTEMS
OR INJURY TO INSTALLER DURING INSTALLATION PROCESS!**



 **CAUTION** 
**TO AVOID DAMAGING THE VEHICLE ALWAYS
USE DRILL STOPS WHEN DRILLING ANY IN-
STALLATION HOLES!**



- IMPORTANT WARRANTY REQUIREMENTS -

1. SUBSTITUTING ADRIAN STEEL SPECIFIED FASTENERS FOR ASSEMBLY AND/OR INSTALLATION WILL VOID YOUR PRODUCT WARRANTY.
2. ALL HOLES DRILLED INTO VEHICLE SHOULD HAVE THE RAW METAL EDGES SEALED WITH A SELF-ETCHING PRIMER TO RESIST CORROSION AND POTENTIAL FASTENER POINT FAILURE.
3. ALL FASTENERS USED IN THE INSTALLATION OF THIS PRODUCT SHOULD BE TIGHTENED TO THE TORQUE(S) SPECIFIED IN THESE INSTRUCTIONS.
4. THESE INSTRUCTIONS SHOULD BE KEPT WITH THE VEHICLE.

THE BASIC TOOLS NEEDED FOR MOST INSTALLATIONS



DRILL



DRILL BIT WITH
STOP



RATCHET, SOCKETS
AND/OR WRENCHES



SCREWDRIVERS





MEASURING TAPE

ADDITIONAL TOOLS MAY BE NEEDED FOR THIS INSTALLATION AND THEY WILL BE IDENTIFIED IN THE STEPS THAT FOLLOW.

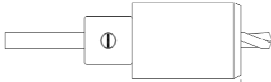

WHEN INSTALLING PLUSNUTS MAKE SURE YOU USE THE CORRECT DRILL BIT WITH A STOP!

PLUSNUT SIZE	DRILL BIT SIZE
1/4-20 PLUSNUT, FAS0052	USE A 3/8" DIAMETER DRILL BIT WITH A STOP.
5/16-18 PLUSNUT, FAS0091	USE A 1/2" DIAMETER DRILL BIT WITH A STOP.
 OR  NOTE: A PLUSNUT SETTING TOOL IS REQUIRED FOR PLUSNUT INSTALLATION AND IS NOT SUPPLIED WITH THIS KIT. ORDER PLUSNUT TOOLS FROM ADRIAN STEEL (P.N. 22200-0) OR USE AN AIR POWERED PLUSNUT SETTING GUN.	
NOTE: If your vehicle contains carpet or a rubber floor mat you will need to prepare the mounting locations using a 1-3/16" carpet cutter.	1-3/16" DIAMETER CARPET CUTTER P.N. 31183-0. 

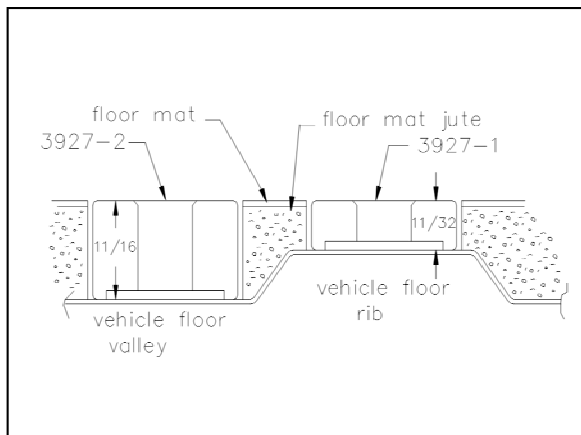

Step 01
Optional Based on Vehicle

If your vehicle contains carpet or a rubber floor mat you will need to prepare the mounting locations. **(if not, skip to STEP 02)**

Position the product to be installed into the vehicle and once you are satisfied with the mounting locations, mark the mounting locations. Using a 1-3/16" diameter carpet cutter. Select the appropriate floor spacers as shown in the illustration to the left. Set those aside for use later into the installation process.

Once you have prepared the carpet/floor mat for mounting, proceed to **STEP 02**.

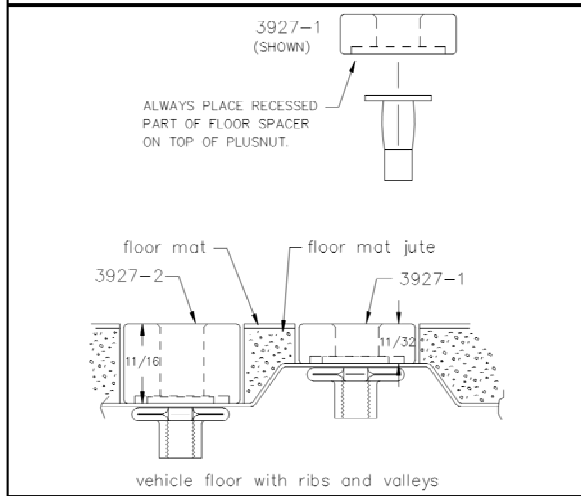

Step 02
Prepare Mounting Locations

Using a drill and drill bit (see table at top of page for correct size) drill the mounting holes in the vehicle sheet metal to prepare for installing the plusnuts.

If you are thru-bolting at any of the locations simply drill a hole that is 1/16" larger than the bolt size(s) for those locations.

Once you have drilled the holes into the vehicle, the raw metal edges should be sealed using a self-etching primer to resist corrosion and potential fastener point failure.

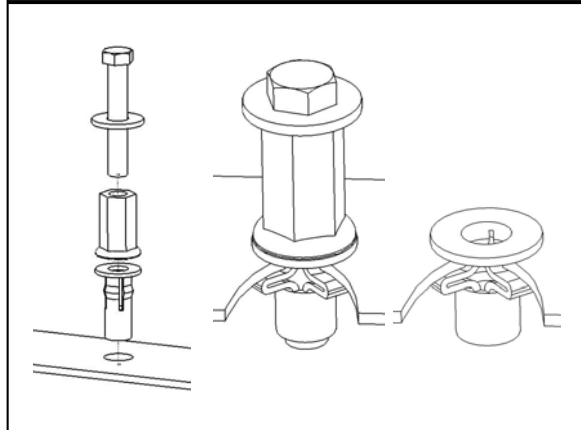

Step 03
Setting Plusnuts

Use a Air Powered Plusnut Setting Gun to "set the plusnut" or if installing manually with hand tools, assembly the following.

1/4-20UNC Plusnut (FAS0052)
FAS0080 SCREW, HXHD, 1/4-20UNCx2.00, G8
FAS0067 WASHER, FLAT, 1/4"ID
22200-0 PLUSNUT TOOL

5/16-18UNC Plusnut (FAS0091)
FAS0095 SCREW, HXHD, 5/16-18UNCx2.00", G8
FAS0086 WASHER, FLAT, 5/16"ID
22200-0 PLUSNUT TOOL

Place barrel of the plusnut body in sheet metal thru hole until flange is flush with sheet metal.

Using a 9/16" combination wrench of plusnut tool body and a second hand wrench, ratchet, or air tool, rotate the hex bolt head CW to draw plus nut flanges up (set the plusnut).

Remove hex bolt, washer, and plusnut. Inspect installation.

Installation and/or Assembly Fasteners
BAGSTEPRD

ITEM NO.	PART NUMBER	DESCRIPTION	
1	BAG0406-A	4" x 6" 3MIL AUTOBAG	1
2	FAS0438	SCREW,HFLNG 5/16-18X.75 ZP	4
3	FAS0440	NUT,HEX NLK FLG 5/16-18 - ZP	4

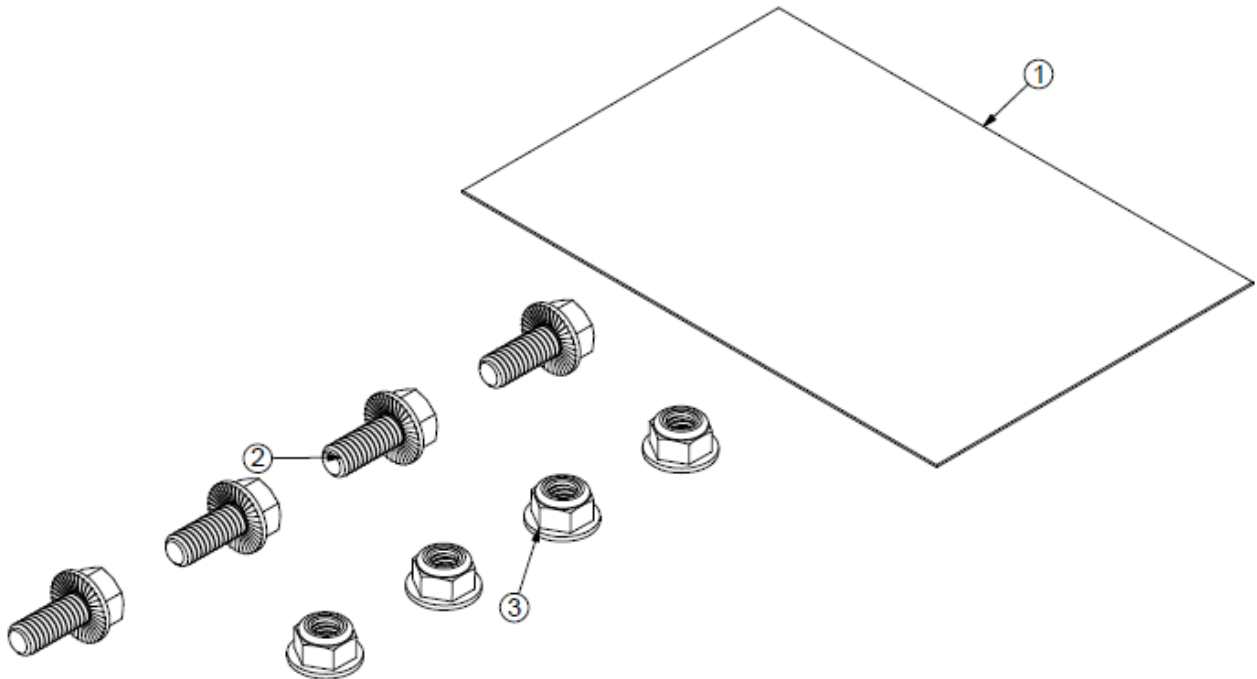

**Installation and/or Assembly Fasteners
BAG62851**

ITEM NO.	PART NUMBER	DESCRIPTION	QTY.
1	FAS0455	SCREW, HH, M12X1.75, 110MM	8
2	FAS0396	NUT, HEX NLK M12-1.75 ZP	8
3	FAS0397	FAS0397 WASHER, FLAT M12X13X2.5 ZP	16
4	BAG0709-A	7" x 9" 3MIL AUTOBAG	1

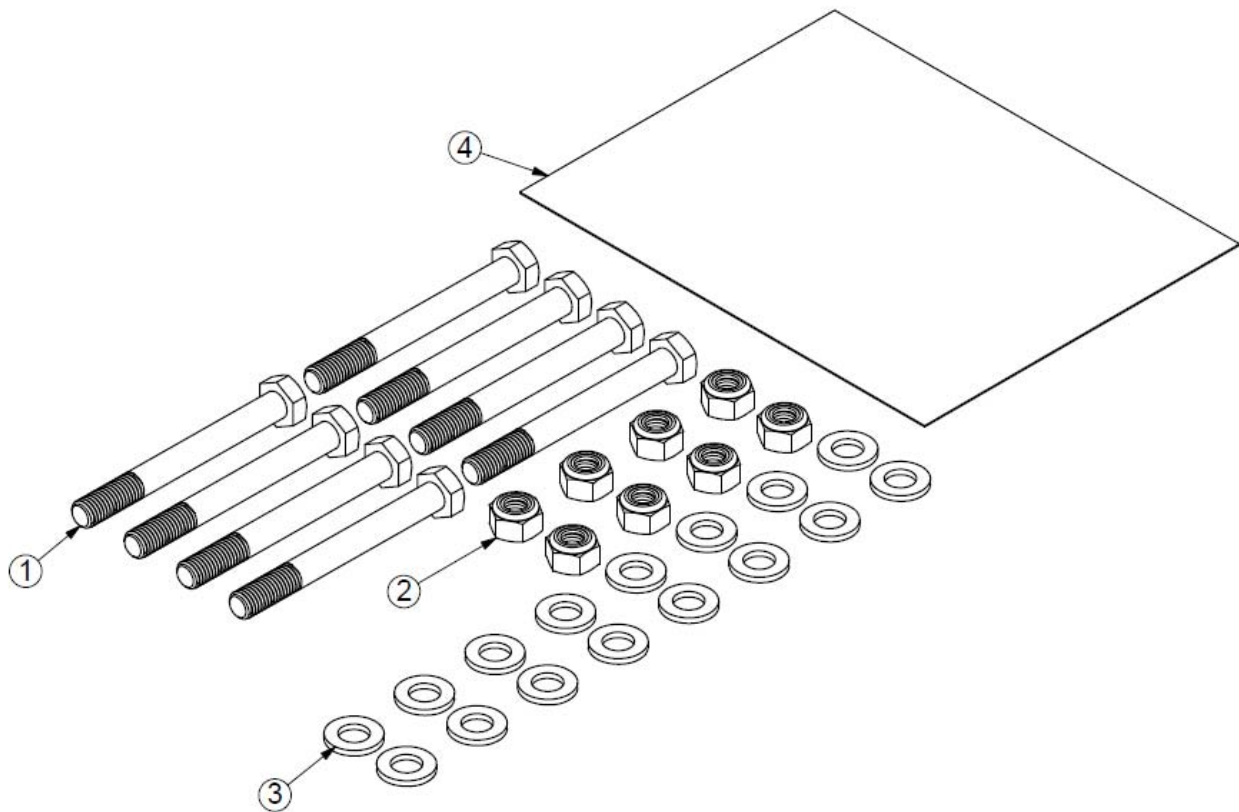

Instructions for Step 01



ORIENTATION OF BRACKETS AT REAR OF SPRINTER

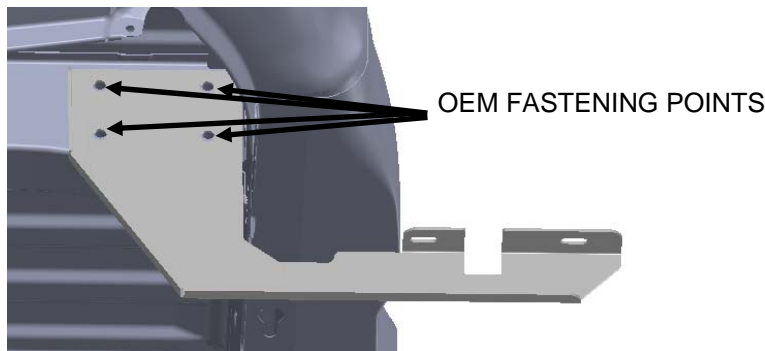

OEM FASTENING POINTS

DRIVER'S SIDE OF VEHICLE

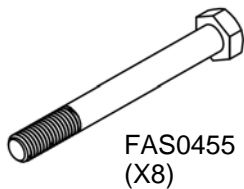

FAS0455 (X8)



FAS0396 (X8)



FAS0397 (X16)

REMOVE THE OEM FASTENERS FROM THE (8) LOCATIONS CALLED OUT ON THE PICTURES TO THE LEFT (IF THEY ARE PRESENT.)

INSTALL BRACKETS IN THE ORENTATIONS SHOWN RE-USING THE OEM FASTENERS THAT WERE JUST REMOVED. IF OEM FASTENERS WERE NOT PRESENT, USE FAS0455, FAS0396, AND FAS0397 SUPPLIED, SHOWN TO THE LEFT.

BE SURE TO KEEP FASTENERS LOOSE AT THIS POINT OF THE INSTALL

OEM FASTENING POINTS

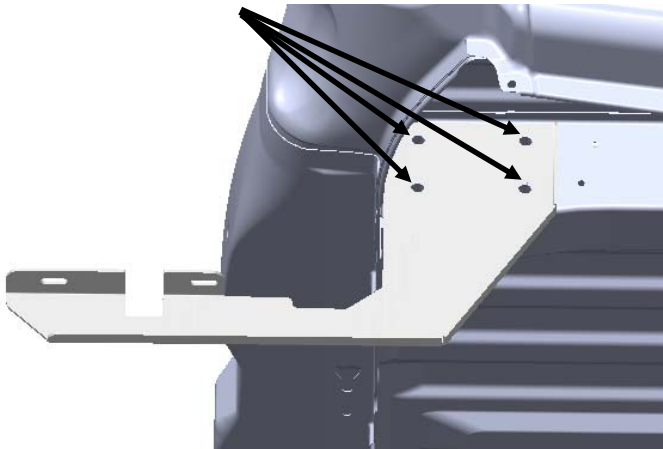

PASSANGER SIDE OF VEHICLE

Instructions for Step 02

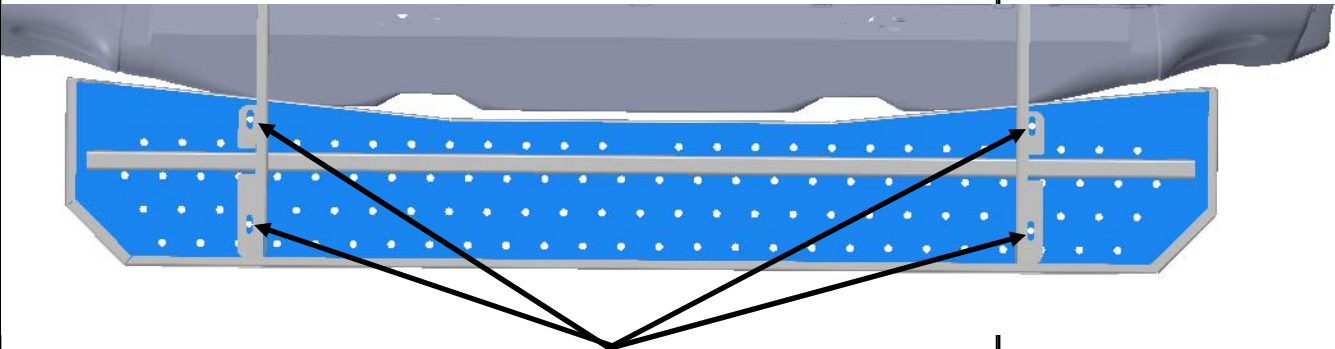

ATTACH STEP TO BRACKETS USING THE (4) HOLES SHOWN ABOVE. THESE HOLES WILL ALSO BE USED FOR ADJUSTMENT IN MAKING THE STEP SQUARE TO THE VEHICLE. USE THE FASTENERS PROVIDED (SHOWN BELOW)



X4



X4

GO BACK AND TIGHTEN UP THE (8) FASTENERS MOUNTING THE BRACKETS TO THE VEHICLE