

PRIME DESIGN™

A Safe Fleet Brand

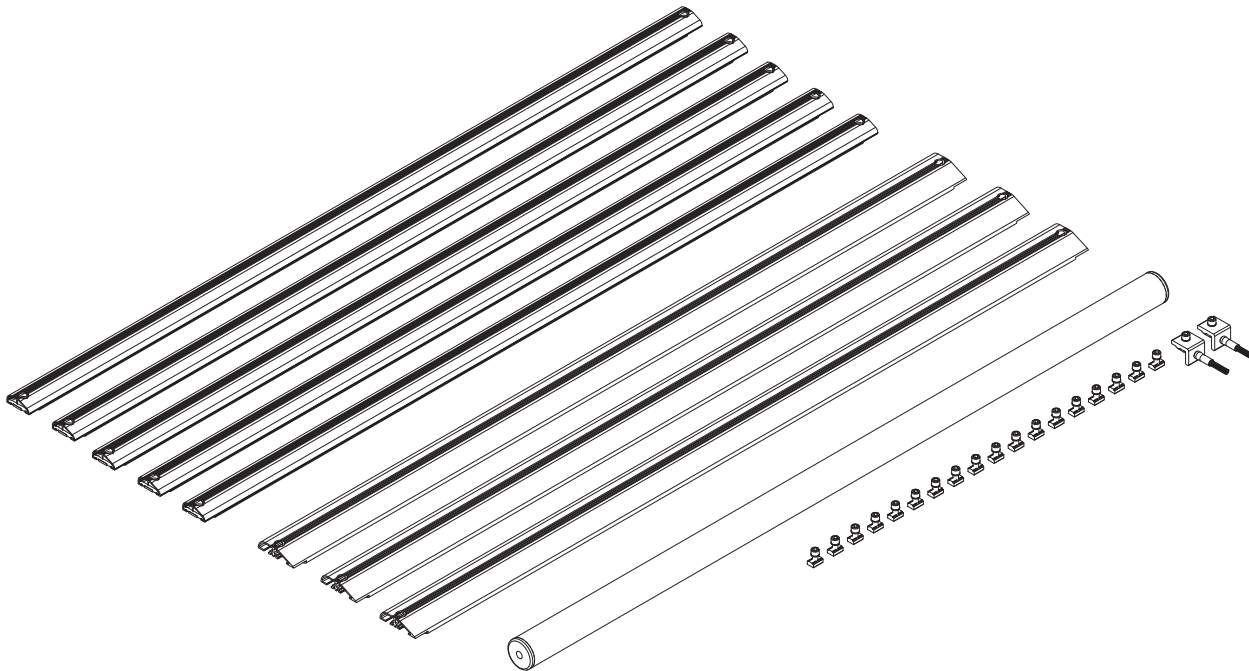

AR-2001 AluRack Crossbar Module, 67" Kit

Page 2	Packaging Contents
Page 3	Strip Nuts and Roller Bracket
Page 4-5	Crossbar Configurations
Page 5-6	Crossbar Installation
Page 6-7	Roller Installation
Page 7	Final Instructions

AR-2001

CONTENTS OVERVIEW

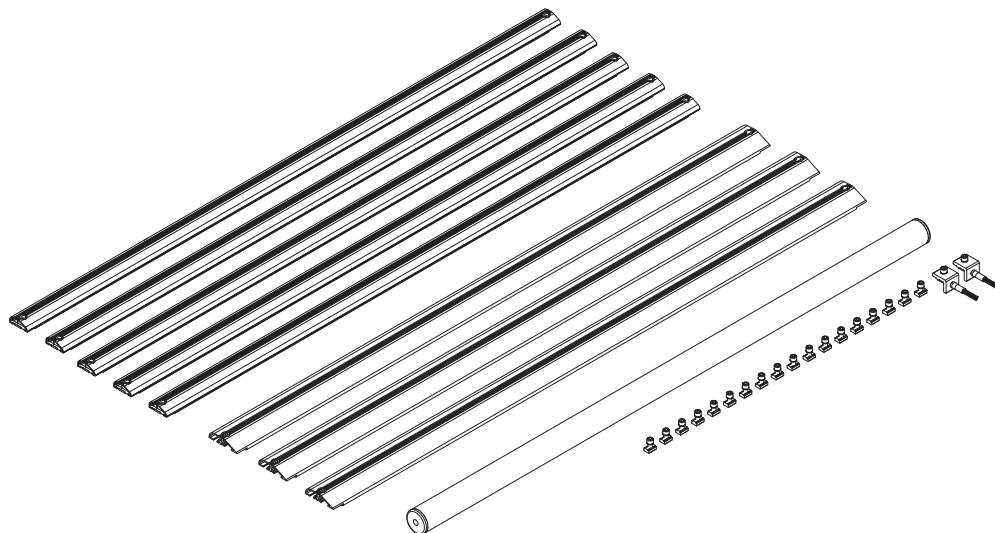

AluRack Heavy Duty Crossbar (Qty 3)
With hardware, 67.00"



AluRack Standard Crossbar (Qty 5)
With hardware, 67.00"



AluRack Roller Assembly (Qty 1)
63.75", with Caps



Crossbar and Roller Hardware (Qty 1)

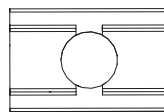

M8 Strip Nut (18X)

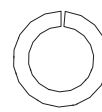

M8 Lock Washer (18X)

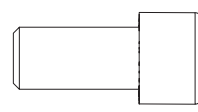

M8 Cap Head Bolt (18X)



Roller Bracket (2X)



Roller Tube Pin (2X)

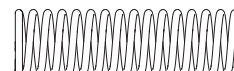

Roller Spring (2X)



Anti-Seize (1X)

STRIP NUT INSTALLATION

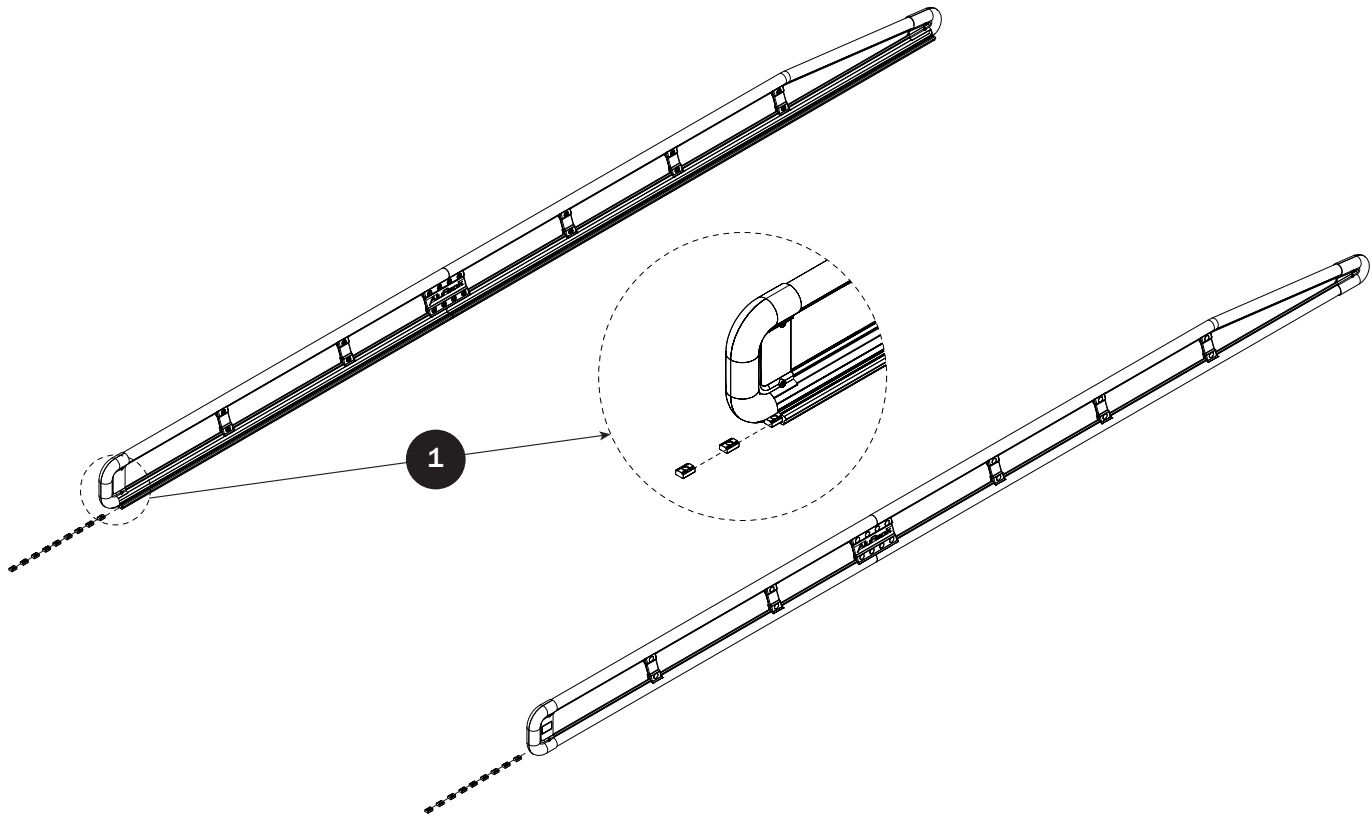

ROLLER BRACKETS

- 2 Install Roller Brackets into the rear most Strip Nuts, and align flush against the rear end of the Side Rail as shown. Torque Roller Bracket Bolts to 90 in-lbs.

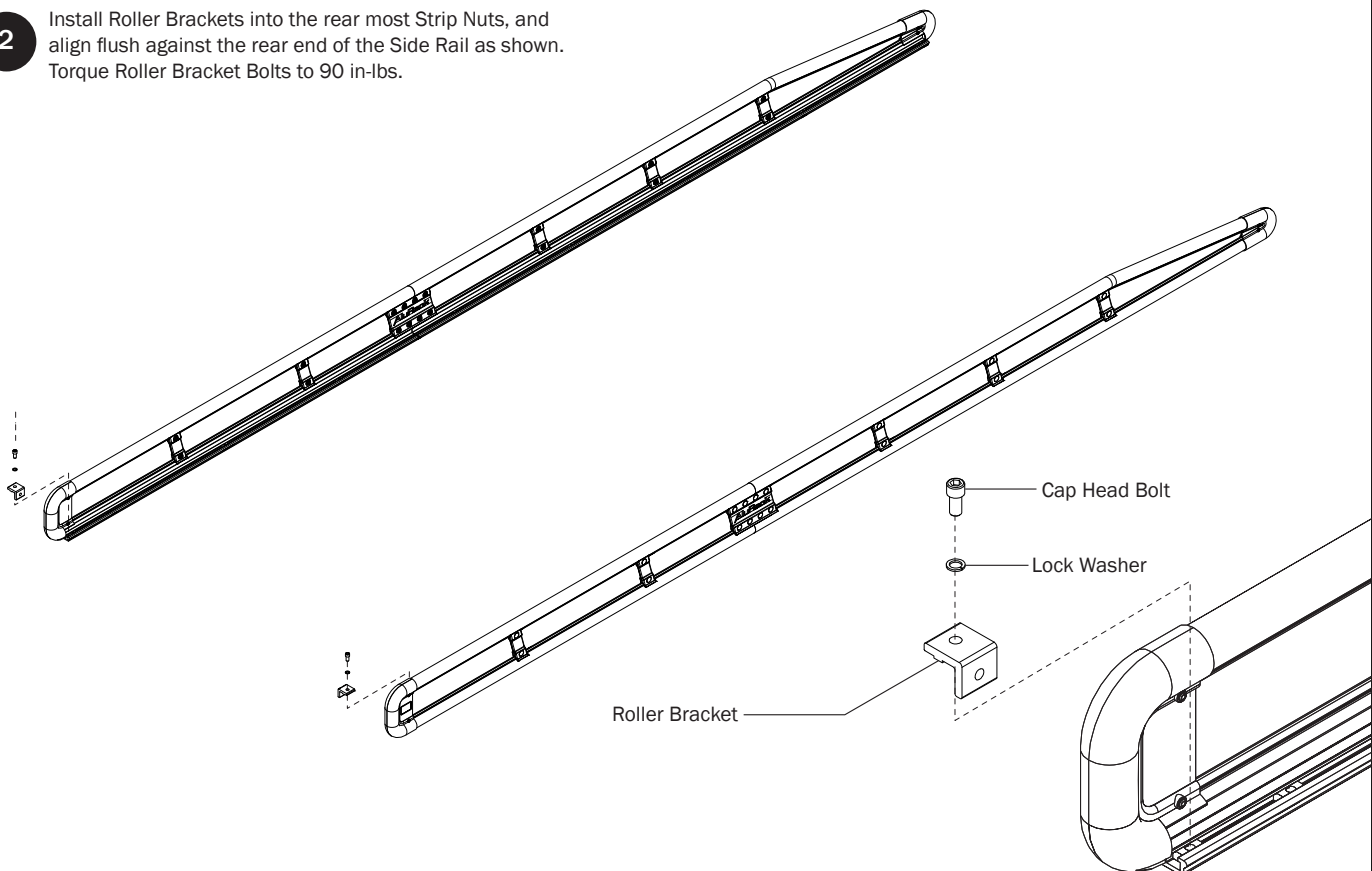

CROSSBAR CONFIGURATIONS

- 3** Measurements are specified according to distances from the Side Rail rear ends. It is recommended to determine your Crossbar pattern before installing them into your Strip Nuts to ensure proper order of use.

*The AluRack shown in Fig.1 is for Illustrative Purposes only, and your Configuration will vary. Refer to the table in Fig. 2 for your product-specific Configuration.

Fig. 1

Rear

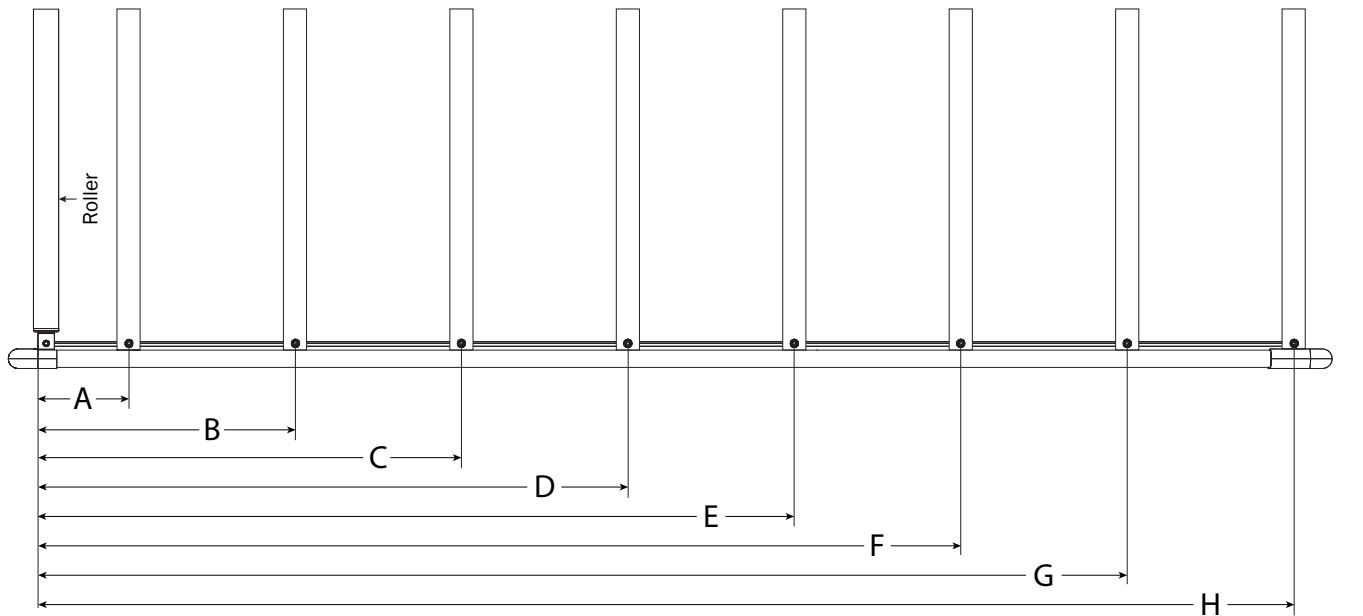

Fig. 2 | STD=STANDARD CROSSBAR | HD=HEAVY DUTY CROSSBAR

PRODUCT	Crossbar A	Crossbar B	Crossbar C	Crossbar D	Crossbar E	Crossbar F	Crossbar G	Crossbar H	FRONT SIDE RAIL END
AR1303-S: GM Van 135"/155" Wheelbase, 84" Roof Height	3.50" STD	15.50" HD	33.00" STD	50.50" STD	68.00" HD	85.50" STD	103.00" HD	Flush to Front Side Rail End	*120.00"
AR1407: ProMaster L1H1 118" Wheelbase, 90" Roof Height	8.50" STD	23.00" HD	37.50" STD	52.00" HD	66.50" STD	81.00" STD	95.50" HD	Flush to Front Side Rail End	*112.00"
AR1413: Promaster L2H2 136" Wheelbase, 101" Roof Height	5.50" STD	21.625" HD	37.50" STD	53.625" HD	69.50" STD	85.50" STD	101.625" HD	Flush to Front Side Rail End	*120.00"
AR1418: ProMaster L2H1 136" Wheelbase, 90" Roof Height	3.50" STD	20.625" HD	39.00" STD	57.50" STD	76.125" HD	94.50" STD	113.125" HD	Flush to Front Side Rail End	*136.00"
AR1423: ProMaster L4H2 159" Wheelbase, 101" Roof Height	4.25" STD	21.375" HD	41.25" STD	61.375" HD	81.25" STD	101.25" STD	121.375" HD	Flush to Front Side Rail End	*144.00"
AR1425: ProMaster L5H2 159"XL Wheelbase, 101" Roof Height	4.50" STD	21.625" HD	42.00" STD	62.625" HD	83.00" STD	103.50" STD	124.125" HD	Flush to Front Side Rail End	*152.00"
AR1900: Nissan NV STD 146" Wheelbase, 84" Roof Height	5.75" STD	24.25" HD	42.75" STD	61.25" STD	79.75" STD	98.25" STD	116.75" HD	Flush to Front Side Rail End	*120.00"
AR1901: Nissan NV HR 146" Wheelbase, 106" Roof Height	3.50" STD	13.50" HD	29.50" STD	45.50" STD	61.50" HD	77.50" STD	93.50" HD	Flush to Front Side Rail End	*112.00"
AR1908: Ford Transit L2H1 130" Wheelbase, 84" Roof Height	6.00" STD	23.25" HD	40.50" STD	57.75" HD	75.00" STD	92.25" HD	109.50" STD	Flush to Front Side Rail End	*128.00"
AR1909: Ford Transit L3H1 148" Wheelbase, 84" Roof Height	5.75" STD	21.00" HD	38.50" STD	56.25" HD	76.25" STD	96.50" STD	117.00" HD	Flush to Front Side Rail End	*144.00"

PRODUCT	Crossbar A	Crossbar B	Crossbar C	Crossbar D	Crossbar E	Crossbar F	Crossbar G	Crossbar H	FRONT SIDE RAIL END
AR1910: Ford Transit L2H2 130" Wheelbase, 101" Roof Height	10.75" STD	25.00" HD	39.25" STD	53.50" HD	67.75" STD	82.00" STD	96.25" HD	Flush to Front Side Rail End	*112.00"
AR1911: Ford Transit L3H3 148" Wheelbase, 110" Roof Height	5.25" STD	23.75" HD	42.25" STD	60.75" STD	79.25" HD	97.75" STD	116.25" HD	Flush to Front Side Rail End	*120.00"
AR1912: Ford Transit L3H2 148" Wheelbase, 101" Roof Height	8.00" STD	23.75" HD	39.50" STD	55.25" HD	71.00" STD	86.75" STD	102.50" HD	Flush to Front Side Rail End	*120.00"
AR1913: Ford Transit L4H3 148"XL Wheelbase, 110" Roof Height	12.00" STD	31.75" HD	51.50" STD	71.25" STD	91.00" HD	110.75" STD	130.50" HD	Flush to Front Side Rail End	*152.00"
AR1928: Sprinter 2007+ L2H1 144" Wheelbase, 99" Roof Height	8.00" HD	24.50" STD	42.50" STD	60.50" HD	78.50" STD	96.50" STD	114.50" HD	Flush to Front Side Rail End	*136.00"

* Side Rail Sizes vary according to customer sizing needs - See respective AR Side Rail Kit Manual to build your Side Rails.
 ** When mounting your AluRack, mounts must attach to the Heavy Duty Crossbars. Customer may adjust distances as needed.
 *** Custom Rack Layouts: Maximum Bolt Spacing on Crossbars and Roller is 24.00". Extra Heavy Duty Crossbars and Hardware are available as needed-contact Sales and Service.

LEFT SIDE RAILS AND CROSSBARS

- Install the Crossbars according to your configuration in the Strip Nuts as shown and torque to 90 in-lbs.



NOTE: Rack shown is for Illustrative Purposes only. The order and placement of Standard Crossbars, Heavy Duty Crossbars, and Roller will vary as shown in Step 1, Fig. 2.

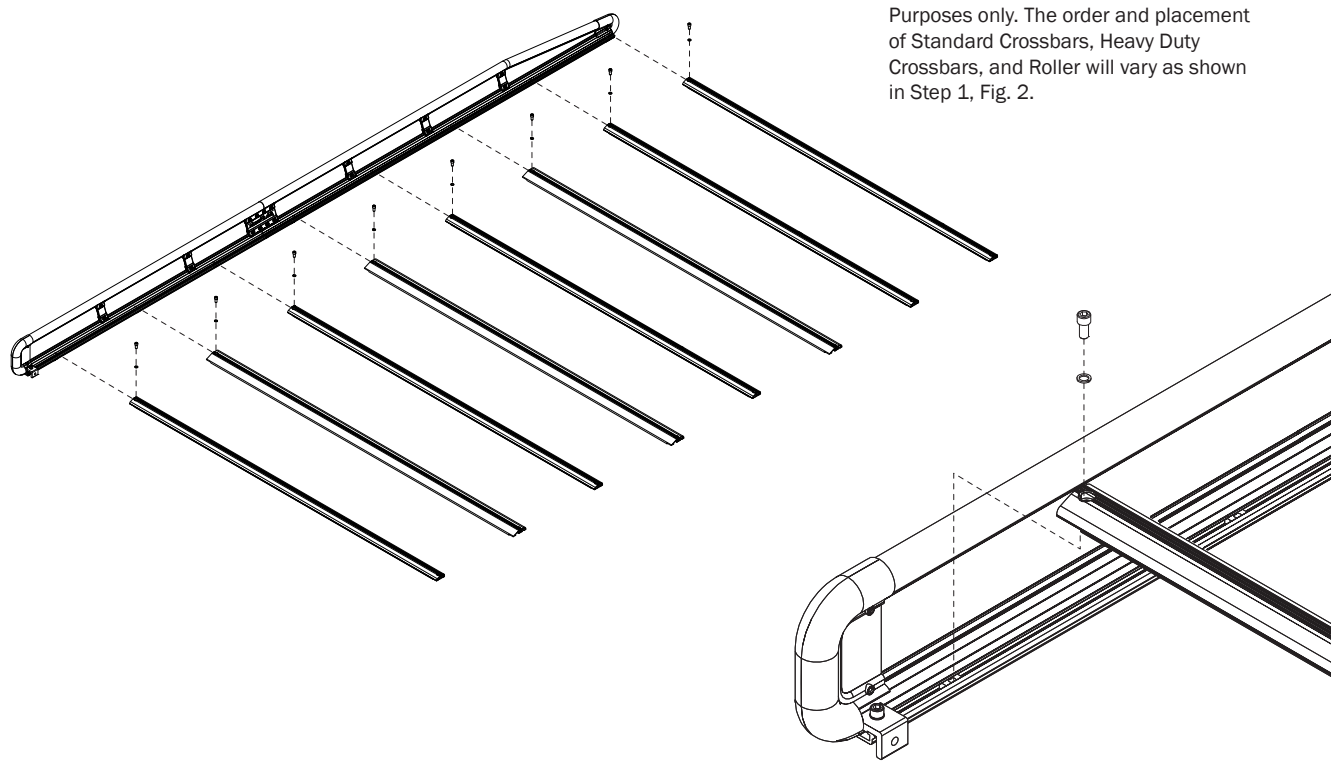

RIGHT SIDE RAILS AND CROSSBARS

- Install the Crossbars according to your configuration in the Strip Nuts as shown and torque to 90 in-lbs.

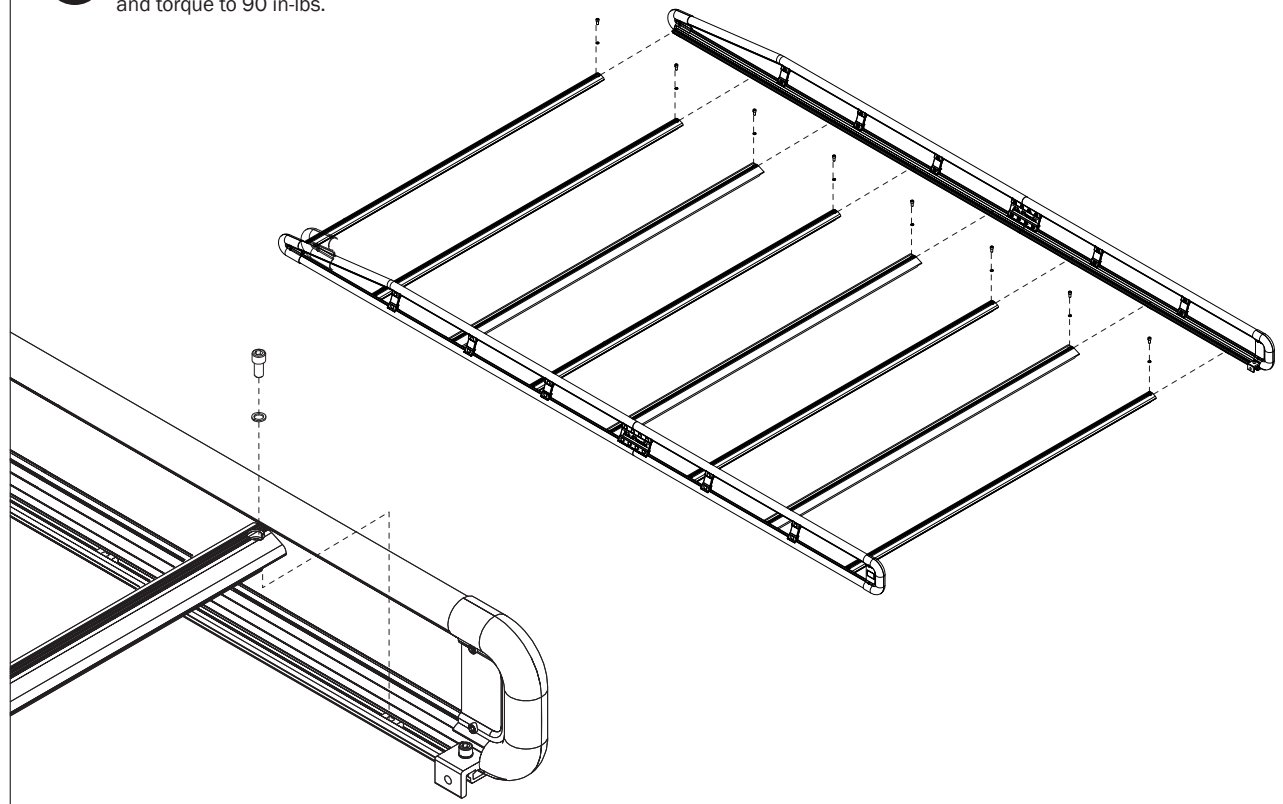

ROLLER ASSEMBLY

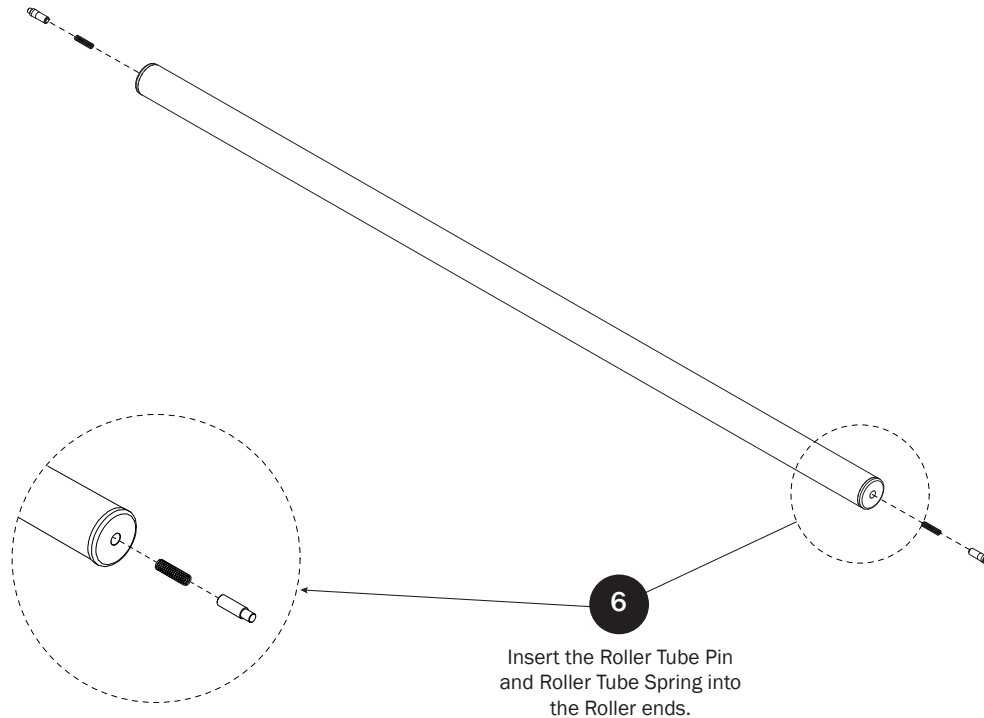

ROLLER INSTALLATION

- 7 Insert the Roller Tube Pin on each side of the Roller Tube into the Brackets as shown.

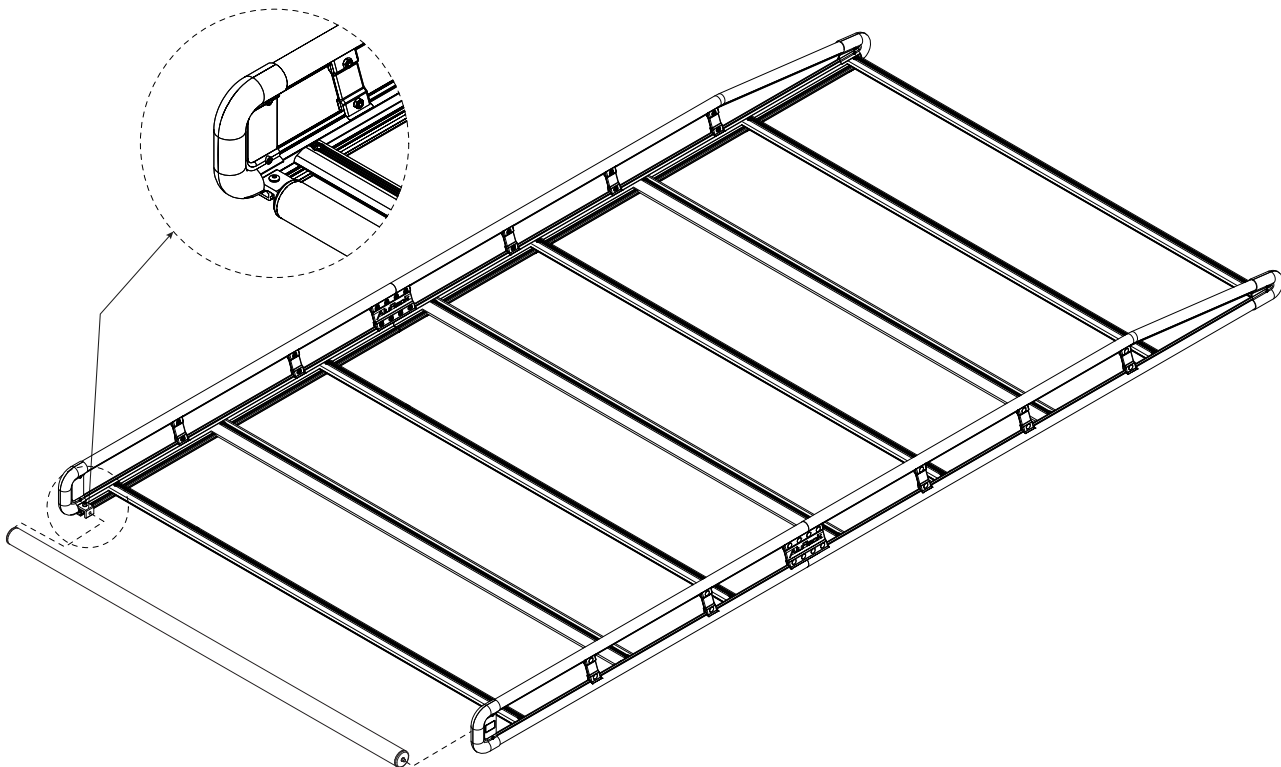

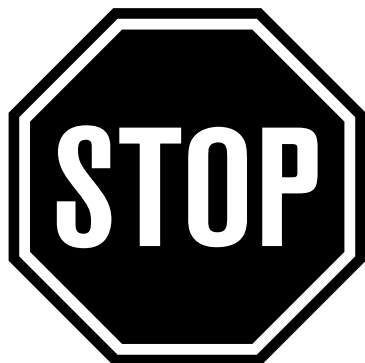
FINAL INSTRUCTIONS**Do not mount the AluRack to an FBM system at this time.**

Refer to the respective FBM Assembly Manual(s) included with your chosen rack configuration features.

WARNING: Failure to position the AluRack as shown in your FBM Assembly Manual may result in damage to the ladder rack.

INSTALLER NOTE: To purchase applicable features and accessories, please contact your authorized distributor, or a Prime Design Sales & Service Representative.

USAM-AR2001-US01 Rev-B 0619